

CODINGS SHOWN WITHOUT LEVER - 1:1

THE DRAWING SHOWS THE 2-DIMENSIONAL REFERENCE COMPONENT CONDITION OF THE ASSEMBLY TO IDENTIFY AND SPECIFY THE NECESSARY DIMENSIONS ONLY. THE DELIVERED PARTS MAY DEVIATE FROM THE DRAWING REGARDING THE ORIENTATION AND POSITION OF EACH COMPONENT (e.g. SLACK CABLE), SO FAR THE FUNCTIONALITY IS NOT CONCERNED.

DIE ZEICHNUNG ZEIGT DEN 2-DIMENSIONALEN IDEALZUSTAND DES ZUSAMMENBAUTEILS BEZÜGLICH DER KOMPONENTEN ZUR IDENTIFIKATION UND SPEZIFIKATION DER NOTWENDIGEN DIMENSIONEN. HINSICHTLICH DER ORIENTIERUNG UND DER LAGE DER KOMPONENTEN (Z.B. BIEGESCHLAPPE KABEL) KÖNNEN DIE DELIEFERTEN TEILE VON DER ZEICHNUNG ABWEICHEN, SOFERN DIE FUNKTIONALITÄT NICHT BEEINTRÄCHTIGT IST.

PROJEKT NR.: PRJ-11-00001983

REVISIONS		DATE	OWN	APPV
NO.	DESCRIPTION			
B2	NOTES AND LABEL LEGEND UPDATED	08OCT2018	JM	JJ
B3	NEW VARIANTS ADDED	12NOV2018	JM	JJ

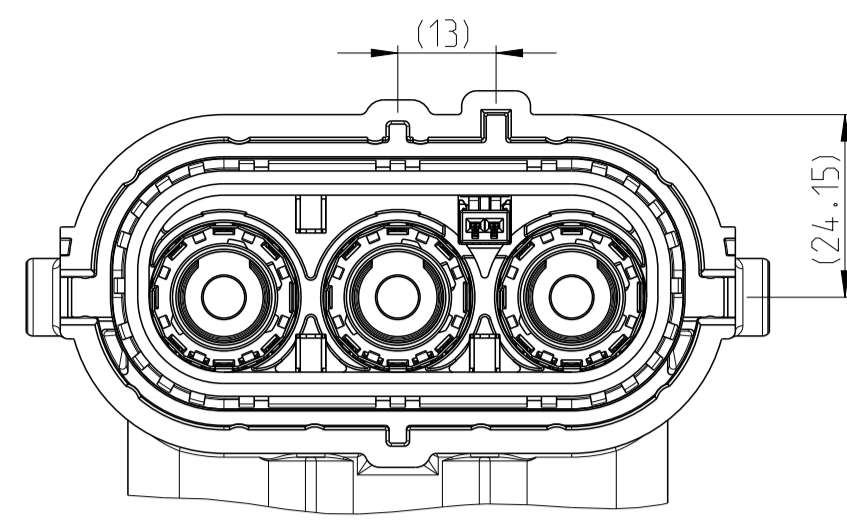

A

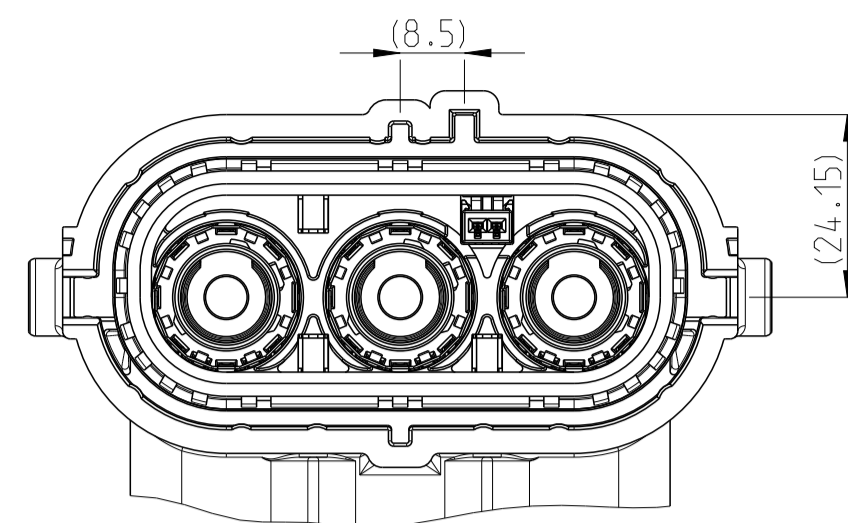

B

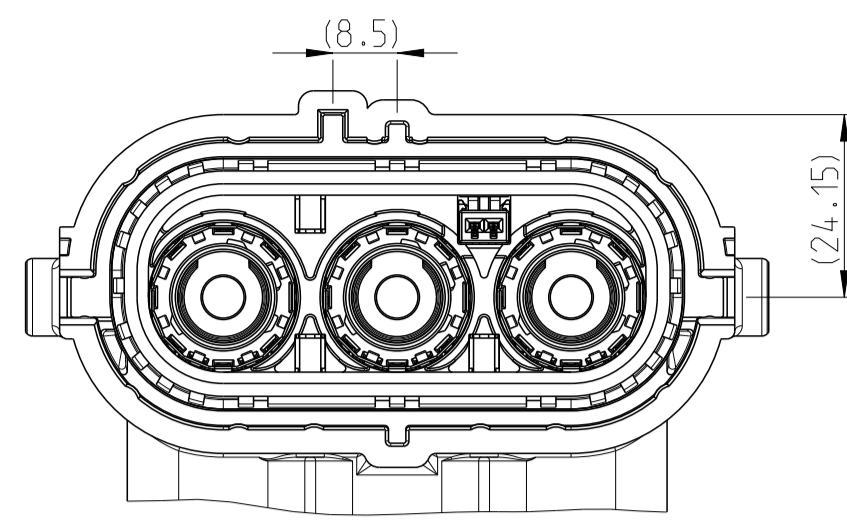

C

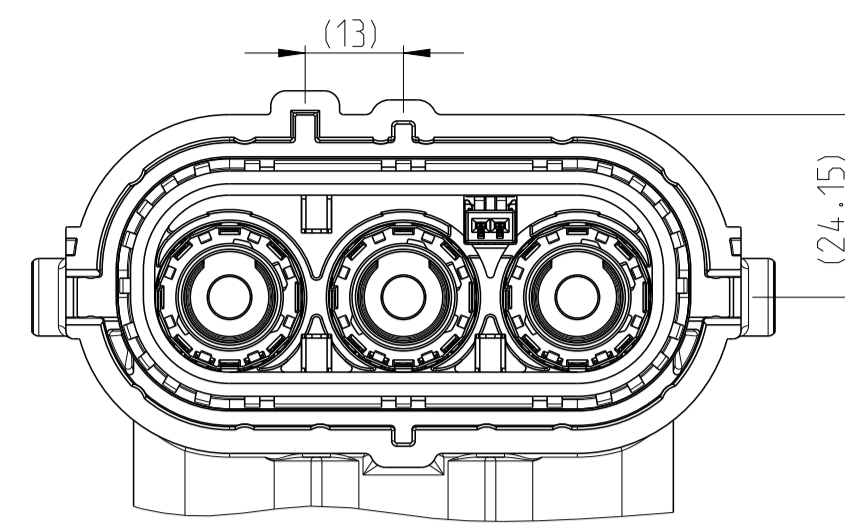

D

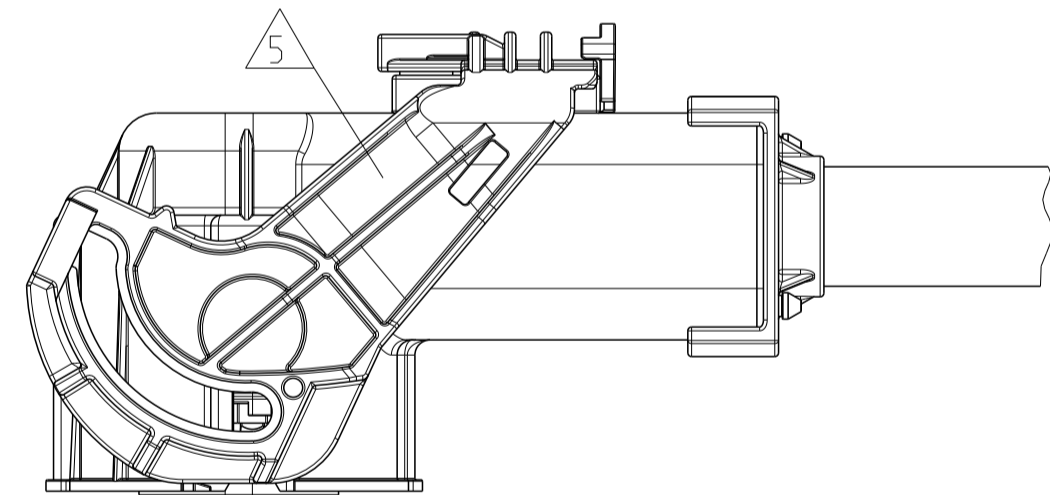
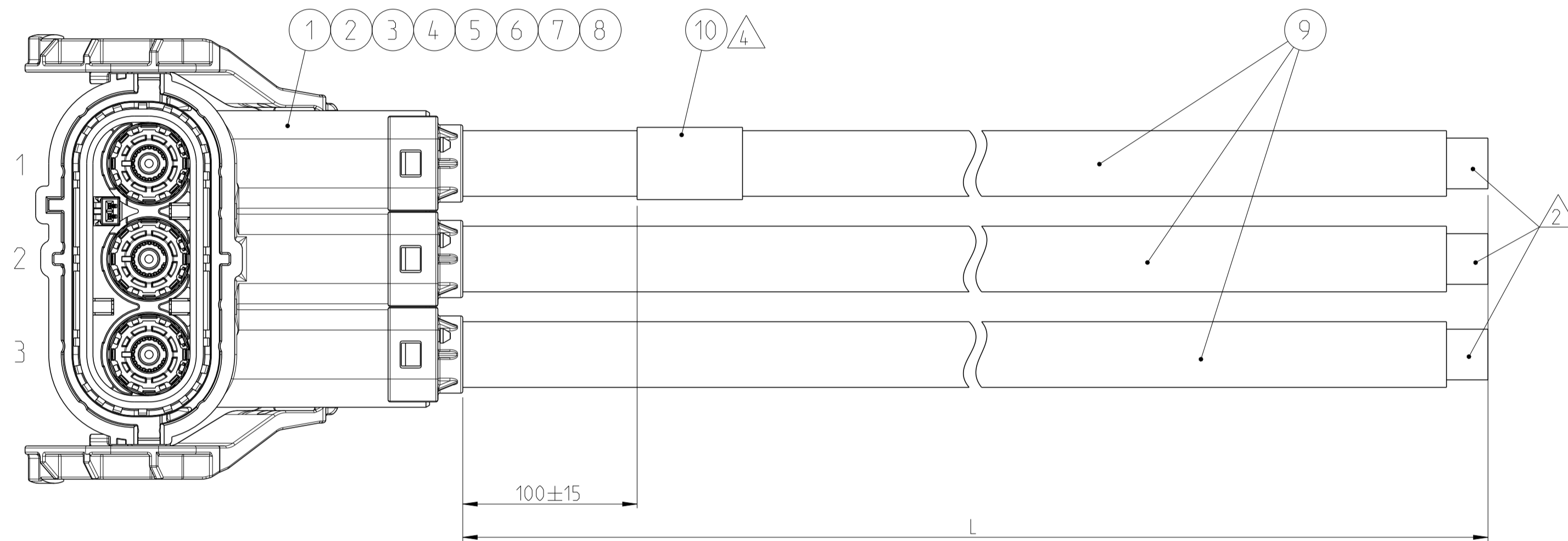

4 LABEL LEGEND:

TE PN: X-2286949-Y Rev. — CURRENT REV.
 DD/MM/YY — DATE CODE
 2.7 kV DC TEST PASSED

NOTES

- PACKAGING:
EACH HOUSING OF THE CABLE ASSEMBLY TO BE INDIVIDUALLY WRAPPED IN FOAM (PN 741639-2) AND FIXED WITH RUBBER BAND (PN 1-2000064-0). PACKED IN TE STANDARD SHIPPING BOX VERTICAL SIDES OVERAID WITH PAPER CUSHIONS (PN 740045-2) ACCORDING TE SPEC. 107-18032. DAMAGED TO BE AVOIDED.
- ELECTRICAL TEST ACCORDING TO SPECIFICATION 108-18857. USE CURRENT REVISION ALWAYS. MIN. 10 mm STRIPPING OF OUTER JACKET AND BRAID FOR ELECTRICAL TEST PURPOSE.
- PRODUCT SPECIFICATION: 108-94268, 108-94256
APPLICATION SPECIFICATION: 114-94052, 114-94083
- MANUFACTURING CODE:
TE PART NO., CURRENT REV. LEVEL AND DATE CODE (DD.MM.YY). TO BE PRINTED ON LABEL (ITEM 10). LABEL TO BE APPLIED TO THE CABLE AFTER SUCCESSFUL ELECTRICAL TEST.
- LEVER POSITION: CLOSED ON DELIVERY.

TE PART NO.	REV.	LENGTH L [mm]	TOL. [mm]	CODING
1-2286949-0	B	500	+30	A
1-2286949-1	B	1000	+30	
1-2286949-2	B	2000	+35	
1-2286949-3	B	3000	+40	
1-2286949-4	B	4000	+50	
1-2286949-5	B	5000	+60	
2-2286949-0	B	500	+30	B
2-2286949-1	B	1000	+30	
2-2286949-2	B	2000	+35	
2-2286949-3	B	3000	+40	
2-2286949-4	B	4000	+50	
2-2286949-5	B	5000	+60	
3-2286949-0	A	500	+30	C
3-2286949-1	A	1000	+30	
3-2286949-2	A	2000	+35	
3-2286949-3	A	3000	+40	
3-2286949-4	A	4000	+50	
3-2286949-5	A	5000	+60	
4-2286949-0	A	500	+30	D
4-2286949-1	A	1000	+30	
4-2286949-2	A	2000	+35	
4-2286949-3	A	3000	+40	
4-2286949-4	A	4000	+50	
4-2286949-5	A	5000	+60	

QTY	QTY	QTY	QTY	DESCRIPTION	ITEM NO.
4-x	3-x	2-x	1-x		
1	1	1	1	LABEL, HELL. TYP 323, 25.4 x 95.25	10
see table	see table	see table	see table	1 POS. POWER CABLE, 50 SQMM	9
3	3	3	3	PROTEC. COVER 8 MM HV, 90 DEG, 50 SQMM	8
3	3	3	3	SINGLE WIRE SEAL, 8 MM HV, 90 DEG, 50 SQMM	7
3	3	3	3	SHIELD CRIMP FERRULE, 90 DEG	6
3	3	3	3	SHIELDING SLEEVE, 90 DEG	5
3	3	3	3	FINGER PROTECTION CAP 8 MM HV, 90 DEG	4
3	3	3	3	HV 8 MM, DEEP DRAWN SOCKET PIN, 90 DEG., ASSEMBLY	3
3	3	3	3	HV 8 MM, DEEP DRAWN SOCKET PIN, 90 DEG., ASSEMBLY	2
1	-	-	-	3 POS. 8 MM HV, REC HSG, 90 DEG, ASSY, SEALED, COD D	1
-	1	-	-	3 POS. 8 MM HV, REC HSG, 90 DEG, ASSY, SEALED, COD C	
-	-	1	-	3 POS. 8 MM HV, REC HSG, 90 DEG, ASSY, SEALED, COD B	
-	-	-	1	3 POS. 8 MM HV, REC HSG, 90 DEG, ASSY, SEALED, COD A	

PRODUCT CHARACTERISTICS ACC. QMP EMEA_12
 BESONDERE MERKMALE NACH QMP EMEA_12

TOLERANCING ISO 8015
 TOLERIERUNG ISO 8015

THIS DRAWING IS A CONTROLLED DOCUMENT.
 DIMENSIONING AND TOLERANCING PER GPS (ISO STANDARDS)

DWN: D. Snajder 10MAR2015
 CHK: J. Jancek 10MAR2015
 APPV: D. Hort 10MAR2015

DIMENSIONS: MASSENHEITEN: mm
 TOLERANCES UNLESS OTHERWISE SPECIFIED: ALLE TOLERANZEN

0 PLC ±
 1 PLC ±
 2 PLC ±
 3 PLC ±
 4 PLC ±

ANGLES/WINKEL: °
 FINISH/OBERFLÄCHE/FARBEN

MATERIAL: -
 WEIGHT/GEWICHT: -

Customer Drawing

STE TE Connectivity

NAME: 3 POS. HVP800, 90. 50 SQMM. CABLE ASSY

SIZE: A1
 CAGE CODE: -
 DRAWING NO: C=2286949
 RESTRICTED TO: NUR FÜR: -

SCALE: 1:1
 SHEET: 1 OF 1
 REV: B3