

HALOGEN BEACONS

24V bulb mounted - 12V bulb included

ECE R 65 (On-Road) - ECE R 10 (Electromagnetic Compatibility)



Different fixations: 3 bolts - flexible - magnetic

Robust polycarbonate lens - Tangential screw motor

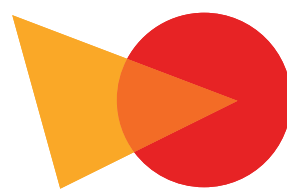

VIGNAL
LIGHTING GROUP

VENUS



Low consumption:
H21 bulbs consumes 60% less than standards H1 bulbs



FLEXI



D14463

Flexi DIN pole (autoblok)
H 169 x Ø 128

D14462

3 bolts
H 117 x Ø 144



D14464

Magnetic / suction cup
H 121 x Ø 144



D14465

Magnetic / suction cup
ROLL CABLE
H 141 x Ø 154

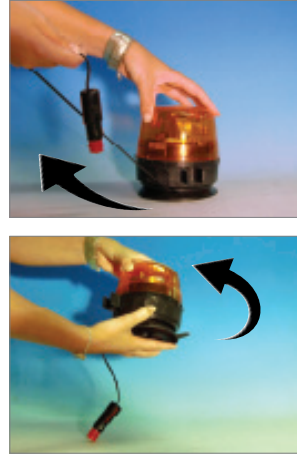

ROLL CABLE
Unwind the exact required cable length!



H21W 12/24V
23W



D14466
Polycarbonate lens

Product highlights :

- Homologated ECE R65 (On-Road) and ECE R10 (EMC)
- **Compact**
- Round shape
- 12 and 24V bulbs included

TAURUS



FLEXI



D14470

Flexi DIN pole (autoblok)
H 203 x Ø 128

D14467

3 bolts
H 154 x Ø 144



D14468

Magnetic / suction cup
H 166 x Ø 144



D14469

Magnetic / suction cup
ROLL CABLE
H 175 x Ø 154

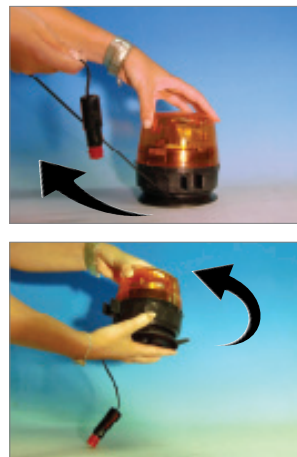

ROLL CABLE
An easier cable runway!



H21W 12/24V
23W



D14471
Polycarbonate lens

Product highlights :

- Homologated ECE R65 (On-Road) and ECE R10 (EMC)
- **Standard size**
- 12 and 24V bulbs included

VEGA



 H1 12/24V

 **D14480**
Polycarbonate lens

Product highlights :

- Homologated ECE R65 (On-Road) and ECE R10 (EMC)
- **Cost effective**
- 12 and 24V bulbs included



FLEXI

D14479
Flexi DIN pole (autoblok)
H 205 x Ø 128



D14477
3 bolts
H 157 x Ø 144



D14478
Magnetic / suction cup
H 176 x Ø 144

ARIES



 H1 12/24V

 **D14461**
Polycarbonate lens

Product highlights :

- Homologated ECE R65 (On-Road) and ECE R10 (EMC)
- **Big size**
- 12 and 24V bulbs included



D14458
1 point
H 149 x Ø 173



D14460
3 bolts
H 149 x Ø 173

D14459
Magnétique / ventouse
H 160 x Ø 173

SATURNE

 H1 12/24V

 **D14476**
Polycarbonate lens



D14475
Flexi DIN pole
H 252 x Ø 155

Product highlights :

- Homologated ECE R65 (On-Road) and ECE R10 (EMC)
- **Flexible rubber base**
- 12 and 24V bulbs included

MULTILUX



D14472

1 point
L 503 x I 235 x H 142

D14473

Magnetic / suction cups
L 503 x I 235 x H 142



H1 12/24V



D14474
Polycarbonate lens

Product highlights :

- Homologated ECE R65 (On-Road) and ECE R10 (EMC)
- Cost effective
- 12 and 24V bulbs included

WATER DROP



D14454

Magnetic / suction cups
H 135 x I 190

D14455

Magnetic / suction cups
H 135 x I 190



H1 12V



D14456 Amber
D14457 Blue
Polycarbonate lens

Product highlights :

- Homologated ECE R65 (On-Road) and ECE R10 (EMC)
- Robust

ACCESSORIES



D14513

Socket to be screwed
ISO 4148/4165



D14514

Socket with central clamp
ISO 4148/4165

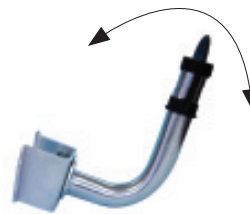

D14515

360° rotating socket
ISO 4148/4165



D14516

Telescopic extension rod
80/135 cm for beacons
ISO 4148/4165



D14511

Flat base



D14512

Angled base



Assembly suggestion



D14565

H21W 12V BAY9s

D14566

H21W 24V BAY9s

Dalroad

Bramingham Business Park, Enterprise Way, Luton, Bedfordshire, LU3 4BU
T: 01582 505 252 | F: 01582 560 060 | W: www.dalroad.com | E: sales@dalroad.com

