

LEUCHTEN-SYSTEME
LIGHTING SYSTEMS



LEUCHTEN-SYSTEME * LIGHTING SYSTEMS

LED-LEUCHTEN-SYSTEM L 250 * LED LIGHTING SYSTEM L 250

Die L250 ist eine sehr kompakte LED-Leuchte, die durch ihre spezielle Optik in beliebigem Winkel (um X-Achse bzw. Fahrzeuglängsmittelachse) am Fahrzeug angebracht werden kann (Ausnahme WBL250). Dadurch lassen sich sehr markante und individuelle Fahrzeug-Hecks gestalten. Einsatz sowohl bei Fahrzeugen mit 12 V- wie auch bei 24 V-Bordspannung (9-32 V Versionen).

The L250 is a very compact LED light, which can be mounted in any angle (X-axis or vehicle longitudinal central axis) (except WBL250). This allows to design very distinctive vehicle rear ends. Can be used on vehicles with both 12 V and 24 V on-board voltage (9-32 V versions).

Merkmale * Features



- Charakteristisches Nacht-Design und beliebiger Winkel
- characteristic night design and mounting in any angle



- Version der Brems-Schlussleuchte mit homogener Ausleuchtung
- homogeneous Stop / Tail Light Version



- Erhältlich als Blink-Brems-Schlussleuchte
- available as DI / Stop / Tail Light



- Mit Microfaser-Membran für optimalen thermodyn. Ausgleich
- with microfibre membrane for optimal thermodynamic balance



- Kombinierbarkeit mit LED-Kontrollbox für Blinkeraustalkontrolle
- combination with device for LED failure control of direction indicator

Technische Daten * Technical Data

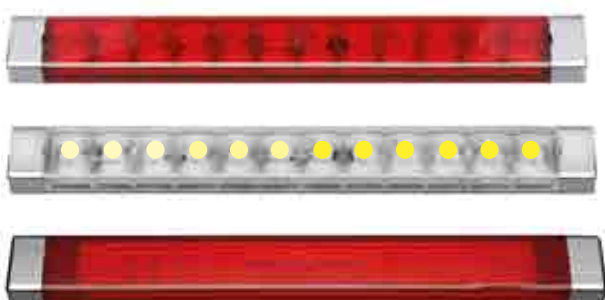

SEQUENZIELLER BLINKER (WBL)
SEQUENTIAL DIRECTION INDICATOR (WBL)

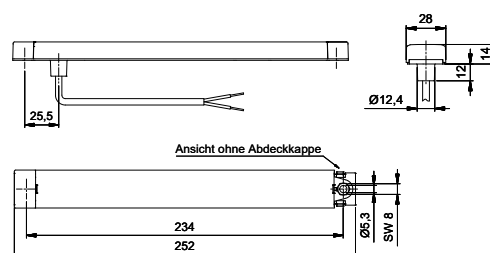

- In beliebigem Winkel (360°/X-Achse) montierbar (Ausnahme WBL)
- Inkl. seil. Kappen (je nach Vers. verchromt od. wie Lichtscheibe)
- Installation rückseitig (M5-Schraube) oder von vorne
- Aufbau-Montage sowie vertiefter Einbau
- Einzelader-Abdichtung für optimale Wasserdichtigkeit
- Inkl. verdeckter Membran für thermodynamischen Ausgleich
- Blinker: mit LDC (LED-Defect-Contr.); kombinierb. mit LK 100-1-X

- can be mounted in any angle (360°/X-axis) (except sequential direction-indicator)
- incl. lateral covers (chrome-plated or like lens dep. on version)
- installation either from the back (M5 screw) or from the front
- surface mounting or flush mounting
- single wire insulation for perfect water tightness
- incl. non visible membrane for thermodynamic balance
- DI function: with LDC (LED-Defect-Control); can be combined with LK 100-1-X

| Bild Picture | Art.-Nr. / No. Typ / Type | Beschreibung Description | Merkmale Features | Spann. Voltage | Leistung Power | Material / Farbe Material / Colour | Anschluss Connection | Gewicht Weight | IP / Temp. IP / Temp. | VP PU | Homolog. Approval |
|--|-------------------------------------|--|---|-------------------|-------------------|--|------------------------------|-------------------|--------------------------|----------|------------------------|
|  | 10.0060.000 BBS 250/12V | LED-Blink-Brems-Schlussleuchte LED DI / Stop / Tail Light |  | 12V DC | 2 / 2 / 1 W | PC/ABS-PC; klar / clear Kappe / cover: chrome | Kabel 500 mm cable 500 mm | 0,09 kg | -20/+50°C IP 67 | 15 | E13-34960 EMV / EMC |
|  | 10.0063.000 BRS 250/12V | LED-Brems-/Schlussleuchte homogen LED Stop / Tail Light homogeneous |  | 12V DC | 2,0 / 0,3 W | PC/ABS-PC; rot / red Kappe / cover: chrome | Kabel 500 mm cable 500 mm | 0,09 kg | -20/+50°C IP 67 | 15 | E13-35447 |
|  | 13.0023.000 S 250/12V | LED-Schlussleuchte, homogen LED Tail Light, homogeneous |  | 12V DC | 0,3 W | PC/ABS-PC; rot / red Kappe / cover: chrome | Kabel 500 mm cable 500 mm | 0,09 kg | -20/+50°C IP 67 | 15 | E13-35447 |
|  | 10.0045.000 BRS 250/9-32V | LED-Brems-/Schlussleuchte LED Stop / Tail Light |  | 9-32V DC | 2,0 / 0,3 W | PC/ABS-PC; rot / red Kappe / cover: chrome | Kabel 500 mm cable 500 mm | 0,09 kg | -20/+50°C IP 67 | 15 | E13-13262 EMV / EMC |
|  | 10.0048.000 BRS 250/12V | LED-Brems-Schlussleuchte LED Stop / Tail Light |  | 12V DC | 2,2 / 0,3 W | PC/ABS-PC; rot / red Kappe / cover: chrome | Kabel 500 mm cable 500 mm | 0,09 kg | -20/+50°C IP 67 | 15 | E13-13262 EMV / EMC |
|  | 13.0019.000 S 250/9-32V | LED-Schlussleuchte LED Tail Light |  | 9-32V DC | 0,3 W | PC/ABS-PC; rot / red Kappe / cover: chrome | Kabel 500 mm cable 500 mm | 0,09 kg | -20/+50°C IP 67 | 15 | E13-13260 EMV / EMC |
|  | 13.0021.000 S 250/12V | LED-Schlussleuchte LED Tail Light |  | 12V DC | 0,3 W | PC/ABS-PC; rot / red Kappe / cover: chrome | Kabel 500 mm cable 500 mm | 0,09 kg | -20/+50°C IP 67 | 15 | E13-13260 EMV / EMC |
|  | 13.2006.000 BR 250/9-32V | LED Bremsleuchte LED Stop Light |  | 9-32V DC | 2,2 W | PC/ABS-PC; rot / red Kappe / cover: chrome | Kabel 500 mm cable 500 mm | 0,09 kg | -20/+50°C IP 67 | 15 | E13-13261 EMV / EMC |
|  | 13.2008.600 BR 250/12V | LED Bremsleuchte LED Stop Light |  | 12V DC | 2,2 W | PC/ABS-PC; klar / clear Kappe / cover: klar / clear | Kabel 500 mm cable 500 mm | 0,09 kg | -20/+50°C IP 67 | 15 | E13-13261 EMV / EMC |
|  | 13.1053.500 BL 250/9-32V | LED-Blinkleuchte Kat. 2a LED DI Light, Cat. 2a |  | 9-32V DC | 2,2 W | PC/ABS-PC; klar / clear Kappe / cover: chrome | Kabel 500 mm cable 500 mm | 0,09 kg | -20/+50°C IP 67 | 15 | E13-13255 EMV / EMC |

LED-LEUCHTEN-SYSTEM L 250 * LED LIGHTING SYSTEM L 250

| Bild Picture | Art.-Nr. / No. Typ / Type | Beschreibung Description | Merkmale Features | Spann. Voltage | Leistung Power | Material / Farbe Material / Colour | Anschluss Connection | Gewicht Weight | IP / Temp. IP / Temp. | VP PU | Homolog. Approval |
|-----------------|---------------------------------------|--|---|-------------------|-------------------|--|------------------------------------|-------------------|---------------------------|----------|------------------------|
| | 13.1069.000 BL 250/12V | LED-Blinkleuchte Kat. 2a <i>LED DI Light, Cat. 2a</i> | mit LED-Defect-Control (LDC) <i>with LED defect control (LDC)</i> | 12V DC | 2,5 W | PC/ABS-PC; klar / <i>clear</i> Kappe / <i>cover: chrome</i> | Kabel 500 mm <i>cabl 500 mm</i> | 0,09 kg | -20/+50°C <i>IP 67</i> | 15 | E13-13255 EMV / EMC |
| | 13.1065.000 WBL 250/12V | LED-Sequentielle Blinkleuchte <i>LED Sequential DI</i> | mit LED-Defect-Control (LDC) <i>with LED defect control (LDC)</i> | 12V DC | 2,5 W | PC/ABS-PC; klar / <i>clear</i> Kappe / <i>cover: chrome</i> | Kabel 500 mm <i>cabl 500 mm</i> | 0,09 kg | -20/+50°C <i>IP 67</i> | 15 | E13-34866 EMV / EMC |
| | 13.3032.000 SN 250/9-32V | LED-Nebelschlussleuchte <i>LED Fog Light</i> | | 9-32V DC | 2,2 W | PC/ABS-PC; rot / <i>red</i> Kappe / <i>cover: chrome</i> | Kabel 500 mm <i>cabl 500 mm</i> | 0,09 kg | -20/+50°C <i>IP 67</i> | 15 | E13-13362 EMV / EMC |
| | 13.6035.000 W 250/9-32V | LED-Rückfahrleuchte <i>LED Reversing Light</i> | | 9-32V DC | 4,5 W | PC/ABS-PC; klar / <i>clear</i> Kappe / <i>cover: chrome</i> | Kabel 500 mm <i>cabl 500 mm</i> | 0,09 kg | -20/+50°C <i>IP 67</i> | 15 | E13-13360 EMV / EMC |
| | 13.6037.000 W 250/12V | LED-Rückfahrleuchte <i>LED Reversing Light</i> | | 12V DC | 5 W | PC/ABS-PC; klar / <i>clear</i> Kappe / <i>cover: chrome</i> | Kabel 500 mm <i>cabl 500 mm</i> | 0,09 kg | -20/+50°C <i>IP 67</i> | 15 | E13-13360 EMV / EMC |
| | 15.0018.100 ZHBL 250b/9-32V | LED-Zusatzbremsleuchte <i>LED High Level Stop Light</i> | Zusatz-Information: <i>Additional Information:</i> mit „D-Zulassung“, d.h. es können auch 2 Leuchten kombiniert werden. <i>with „D Approval“, i.e. also 2 lights can be combined.</i> | 9-32V DC | 1 W | PC/ABS-PC; rot / <i>red</i> Kappe / <i>cover: rot / red</i> | Kabel 500 mm <i>cabl 500 mm</i> | 0,09 kg | -20/+50°C <i>IP 67</i> | 15 | E13-13365 EMV / EMC |
| | 31.0017.000 R 250 r/cr | Rückstrahler <i>Reflex Reflector</i> | | | | PC/ABS-PC; rot / <i>red</i> Kappe / <i>cover: chrome</i> | | 0,05 kg | -20/+50°C <i>IP 67</i> | 15 | E13-13361 |

Zubehör / Ersatzteile * Accessories / Spare parts

| | | | | | | | | | | | |
|--|-------------------------------------|---|---|------|----------|--|--|----------|---------------------------|---|-----|
| | 19.2035.000 | Abdeckkappen (Paar) chrom <i>covers (pair) chrome</i> | | | | | | 0,007 kg | | | |
| | 19.2035.100 | Abdeckkappen (Paar) rot <i>covers (pair) red</i> | | | | | | 0,006 kg | | | |
| | 19.2035.200 | Abdeckkappen (Paar) gelb <i>covers (pair) yellow</i> | | | | | | 0,006 kg | | | |
| | 19.2035.300 | Abdeckkappen (Paar) grau <i>covers (pair) grey</i> | | | | | | 0,006 kg | | | |
| | 62.3001.002 LK 100b-1/12V | LED-Kontrollbox (Blinker) <i>LED Control Device (DI)</i> | Schaltsw/Threshold: 25 mA (I=const.) | 12 V | 2 x 21 W | Aluminium / PU schwarz - <i>black</i> | Kabel 2x1500mm <i>cabl 2x1500mm</i> | 0,40 kg | -20/+50°C <i>IP 67</i> | 1 | EMV |
| | 62.3002.012 LK 100-1/24V | LED-Kontrollbox (Blinker) <i>LED Control Device (DI)</i> | Schaltsw/Threshold: 20 mA (I=const.) | 24 V | 2 x 21 W | Aluminium / PU schwarz - <i>black</i> | Kabel 2x1500mm <i>cabl 2x1500mm</i> | 0,40 kg | -20/+50°C <i>IP 67</i> | 1 | EMV |

LED-LEUCHTEN-SYSTEM L 260 * LED LIGHTING SYSTEM L 260

Das Leuchtensystem L 260 besticht durch sein modernes und äußerst homogenes Erscheinungsbild der leuchtenden Flächen, verbunden mit einer sehr kompakten, stabförmigen Bauform mit verdeckter Schraubbefestigung. Die LED-Leuchten sind anschlussfertig, wasserdicht vergossen, mit einer Druckausgleichsmembran versehen und verfügen über ein Anschlusskabel von 500 mm Länge. Die Leuchten sind für den Aufbau und für den Einbau geeignet.

The L 260 lighting system impresses with its modern and extremely homogeneous appearance of the luminous surfaces, combined with a very compact, bar-shaped design with concealed screw fixing. The LED lights are ready for plug-in, waterproof sealed, equipped with a non-visible membrane for thermodynamic balance and have a connecting cable of 500 mm length. The lights are suitable for surface mounting and flush mounting.

Merkmale * Features



- Charakteristisches Nachtdesign und innovative Technik
- *characteristic night design and innovative technology*



- Marken LEDs von Osram und Nichia für lange Lebensdauer
- *High-Grade LEDs from Osram and Nichia for long life time*



- Einzeldaderabdichtung für maximalen IP-Schutz und Funktionssicherheit
- *single wire insulation for high IP protection class and max. reliability*



- Mit Microfaser-Membran für optimalen thermodyn. Ausgleich
- *with microfibre membrane for optimal thermodynamic balance*



- Kombinierbar mit LED-Kontrollbox für Blinkerausfallkontrolle
- *combination with device for LED failure control of direction indicator*



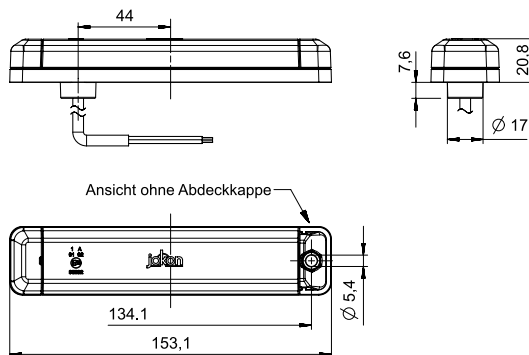



Technische Daten * Technical Data

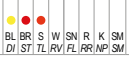

Ansicht ohne Abdeckkappe

- Inkl. schwarzer Abdeckkappen (Farbvarianten auf Anfrage)
- Aufbau-Montage sowie vertiefter Einbau
- Einzeldader-Abdichtung für optimale Wasserdichtigkeit
- Inkl. verdeckter Membran für thermodynamischen Ausgleich
- Blinker: mit LDC (LED-Defect-Contr.); kombinierb. mit LK 100b-1

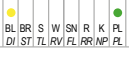
- *incl. black cover caps (colour variants on request)*
- *surface mounting or flush mounting*
- *single wire insulation for perfect water tightness*
- *incl. non visible membrane for thermodynamic balance*
- *DI function: with LDC (LED-Defect-Control); can be combined with LK 100b-1*

| Bild Picture | Art.-Nr. / No. Typ / Type | Beschreibung Description | Merkmale Features | Spann. Voltage | Leistung Power | Material / Farbe Material / Colour | Anschluss Connection | Gewicht Weight | IP / Temp. IP / Temp. | VP PU | Homolog. Approval |
|---|---------------------------------------|--|--|-------------------|-------------------|--|------------------------------|-------------------|--------------------------|----------|-----------------------|
|  | auf Anfrage/on request BBS 260/12V | LED-Blink-Brems-Schlussleuchte LED DI / Stop / Tail Light |  | 12V DC | | PC - klar / clear ABS-PC - schwarz/ black | Kabel 500 mm cable 500 mm | | IP 67 | | |
|  | auf Anfrage/on request BBS 260/24V | LED-Blink-Brems-Schlussleuchte LED DI / Stop / Tail Light |  | 24V DC | | PC - klar / clear ABS-PC - schwarz/ black | Kabel 500 mm cable 500 mm | | IP 67 | | |
|  | 11.0026.000 BP 260/12V | LED-Blink-Begrenzungsleuchte LED-DI / Marker Light |  | 12V DC | 2,0 / 1,0 W | PC - klar / clear ABS-PC - schwarz/ black | Kabel 500 mm cable 500 mm | | -20/+50°C IP 67 | 16 | E13-35232 EMV/ EMC |
| | | Zusatz-Information: Additional Information: | mit LED-Defect-Control (LDC) / Impulsgeber with LED defect control (LDC) / Impuls | | | | | | | | |
|  | 11.0027.000 BP 260/12V | LED-Blink-Begrenzungsleuchte LED-DI / Marker Light |  | 12V DC | 2,0 / 1,0 W | PC - klar / clear ABS-PC - schwarz/ black | Kabel 500 mm cable 500 mm | | -20/+50°C IP 67 | 16 | E13-35232 EMV/ EMC |
| | | Zusatz-Information: Additional Information: | mit LED-Defect-Control (LDC) with LED defect control (LDC) | | | | | | | | |

Zubehör / Ersatzteile * Accessories / Spare parts

| | | | | | | | | | | | |
|---|-------------------------------------|--|--|------|----------|-----------------------------------|----------------------------------|---------|--------------------|---|-----------|
|  | 62.3001.002 LK 100b-1/12V | LED-Kontrollbox (Blinker) LED Control Device (DI) | Schaltsw/Threshold 25 mA (I=const.) | 12 V | 2 x 21 W | Aluminium / PU schwarz - black | Kabel 2x1500mm cable 2x1500mm | 0,40 kg | -20/+50°C IP 67 | 1 | EMV / EMC |
|---|-------------------------------------|--|--|------|----------|-----------------------------------|----------------------------------|---------|--------------------|---|-----------|

LEUCHTEN-SYSTEME
LIGHTING SYSTEMS



LED-LEUCHTEN-SYSTEM L 112 * LED LIGHTING SYSTEM L 112

Das Leuchtensystem L 112 mit einem Außendurchmesser von 112 mm stellt eine gelungene Symbiose aus Saphira Lichttechnik und vollhomogener Diffusor-Optik der Schlusslichtfunktion dar. Die LED-Leuchten sind anschlussfertig, wasserdicht vergossen, mit einer Druckausgleichsmembrane versehen und verfügen über ein Anschlusskabel von 500 mm Länge. Die Leuchten sind für den Einbau und für den Aufbau geeignet. In Verbindung mit SNWS 115 doppelte Schlusslichtfunktion, natürlich mit entsprechender D-Zulassung (ECE R48).

The L 112 lighting system with an outer diameter of 112 mm represents a successful symbiosis of Saphira lighting technology and fully homogeneous diffuser optics for the taillight function. The LED lights are ready for plug-in, waterproof sealed, equipped with a non-visible membrane for thermodynamic balance and have a connecting cable of 500 mm length. The lights are suitable for surface mounting and flush mounting. Together with SNWS 115 double tail light function with corresponding D-approval (ECE R48).

Merkmale * Features



- Charakteristisches Nacht-Design und innovative Technik
- characteristic night design and innovative technology



- Marken LEDs von Osram für lange Lebensdauer
- High-Grade LEDs from Osram for long life time



- Einzeldraderabdichtung für maximalen IP-Schutz und Funktionssicherheit
- single wire insulation for high IP protection class and max. reliability



- Mit Microfaser-Membran für optimalen thermodyn. Ausgleich
- with microfibre membrane for optimal thermodynamic balance



- Kombinierbar mit LED-Kontrollbox für Blinkerausfallkontrolle
- combination with device for LED failure control of direction indicator

Technische Daten * Technical Data

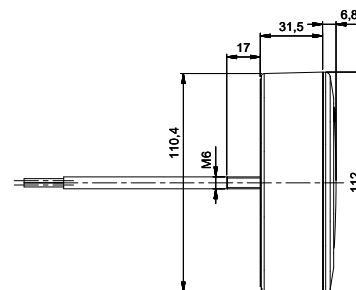
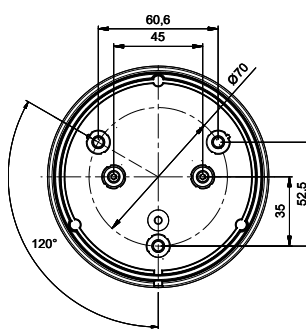

- Schlusslicht mit homogener Diffusor-Optik
- D-Zulassung für doppelten Anbau der Schlusslichtfunktion
- Befestigung über integrierte Gewindebolzen
- Einzeldrader-Abdichtung für optimale Wasserdichtigkeit
- Inkl. verdeckter Membran für thermodynamischen Ausgleich
- Blinker: mit LDC (LED-Defect-Contr.); kombinierb. mit LK 100b-1

- taillight with homogeneous diffuser optics
- D-approval for double mounting of the tail light function
- mounting via integrated threaded bolts
- single wire insulation for perfect water tightness
- incl. non visible membrane for thermodynamic balance
- DI function: with LDC (LED-Defect-Control) for combination with LK control device

| Bild Picture | Art.-Nr. / No. Typ / Type | Beschreibung Description | Merkmale Features | Spann. Voltage | Leistung Power | Material / Farbe Material / Colour | Anschluss Connection | Gewicht Weight | IP / Temp. IP / Temp. | VP PU | Homolog. Approval |
|-----------------|------------------------------------|---|---|-------------------|-------------------|---|------------------------------|-------------------|--------------------------|----------|------------------------|
| | 10.1042.000 BBS 112/12V | LED-Blink-Brems-Schlussleuchte LED DI / Stop / Tail Light | BL BR S W SN R K SM DI ST TL RV FL RRI NP SM | 12V DC | 3 / 5 / 5 W | PC - klar-rot / clear-red ABS-PC - schwarz / black | Kabel 500 mm cable 500 mm | 0,22 kg | -20/+50°C IP 67 | 12 | E13-35099 |
| | 10.1042.500 BBS 112/24V | LED-Blink-Brems-Schlussleuchte LED DI / Stop / Tail Light | BL BR S W SN R K SM DI ST TL RV FL RRI NP SM | 24V DC | 3 / 5 / 5 W | PC - klar-rot / clear-red ABS-PC - schwarz / black | Kabel 500 mm cable 500 mm | 0,22 kg | -20/+50°C IP 67 | 12 | E13-35099 |
| | 13.3118.000 SNWS 112/12V | LED-Nebelschl.-Rückfahr-Schlussl. LED Fog/Reverse/Tail Light | BL BR S W SN R K SM DI ST TL RV FL RRI NP SM | 12V DC | 3 / 5 / 5 W | PC - klar-rot / clear-red ABS-PC - schwarz / black | Kabel 500 mm cable 500 mm | 0,23 kg | -20/+50°C IP 67 | 12 | E13-35099 E13-35862 |
| | 13.3118.500 SNWS 112/24V | LED-Nebelschl.-Rückfahr-Schlussl. LED Fog/Reverse/Tail Light | BL BR S W SN R K SM DI ST TL RV FL RRI NP SM | 24V DC | 3 / 5 / 5 W | PC - klar-rot / clear-red ABS-PC - schwarz / black | Kabel 500 mm cable 500 mm | 0,23 kg | -20/+50°C IP 67 | 12 | E13-35099 E13-35862 |

Zubehör / Ersatzteile * Accessories / Spare parts

| | | | | | | | | | | | |
|--|-------------------------------------|--|--|------|----------|-----------------------------------|----------------------------------|---------|--------------------|---|-----|
| | 62.3001.002 LK 100b-1/12V | LED-Kontrollbox (Blinker) LED Control Device (DI) | Schaltsw./Thresholt 25 mA (=const.) | 12 V | 2 x 21 W | Aluminium / PU schwarz - black | Kabel 2x1500mm cable 2x1500mm | 0,40 kg | -20/+50°C IP 67 | 1 | EMV |
| | 62.3002.012 LK 100-1/24V | LED-Kontrollbox (Blinker) LED Control Device (DI) | Schaltsw./Thresholt 20 mA (=const.) | 24 V | 2 x 21 W | Aluminium / PU schwarz - black | Kabel 2x1500mm cable 2x1500mm | 0,40 kg | -20/+50°C IP 67 | 1 | EMV |

LED-LEUCHTEN-SYSTEM L 115* LED LIGHTING SYSTEM L 115

Die LED-Leuchten Typ L 115 mit homogener Schlusslichtfunktion, Einzeladerabdichtung und einer Goretexmembran zum Druckausgleich bzw. Abführung von Feuchtigkeit. Schraublöcher werden durch den dekorativen Chromring verdeckt. In Verbindung mit SNWS 115 doppelte Schlusslichtfunktion, natürlich mit entsprechender D-Zulassung (ECE-R 48).

The LED lights type L 115 with homogeneous tail light function, single wire sealing and a Goretex membrane for pressure compensation or moisture dissipation. Screw holes are concealed by the decorative chrome ring. In conjunction with SNWS 115 double tail light function, of course with corresponding D approval (ECE-R 48).

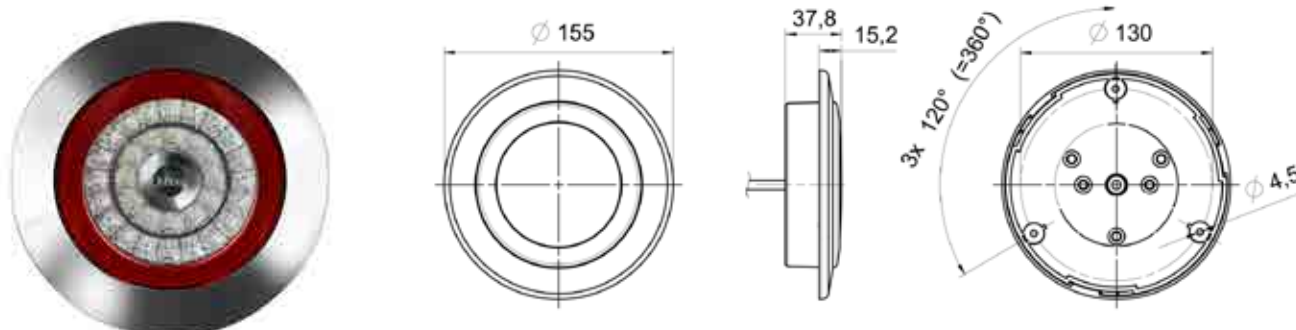

- Schlusslicht mit homogener Diffusor-Optik
- D-Zulassung für doppelten Anbau der Schlusslichtfunktion
- Befestigungsöffnungen durch Chromring verdeckt
- Einzelader-Abdichtung für optimale Wasserdichtigkeit
- Inkl. verdeckter Membran für thermodynamischen Ausgleich
- Blinker: mit LDC (LED-Defect-Contr.); kombinierb. mit LK 100b-1
- taillight with homogeneous diffusor optics
- D-approval for double mounting of the tail light function
- screw holes hidden by chrome ring
- single wire insulation for perfect water tightness
- incl. non visible membrane for thermodynamic balance
- DI function: with LCD (LED-Defect-Control) for combination with LK control device

| Bild Picture | Art.-Nr. / No. Typ / Type | Beschreibung Description | Merkmale Features | Spann. Voltage | Leistung Power | Material / Farbe Material / Colour | Anschluss Connection | Gewicht Weight | IP / Temp. IP / Temp. | VP PU | Homolog. Approval |
|-----------------|------------------------------------|--|--|-------------------|-------------------|---------------------------------------|--------------------------------|-------------------|--------------------------|----------|------------------------|
| | 10.1043.000 BBS 115/12V | LED-Blink-Brems-Schlussleuchte LED DI / Stop / Tail Light | BL BR S W SN R K SM DI ST TL RV FL RR NP SM | 12 V | 4/3/3 W | PMMA / PC/ ABS | Kabel 500 mm cable 500 mm | 0,30 kg | -20/+50°C IP 67 | 12 | E13-35099 |
| | 10.1043.500 BBS 115/24V | LED-Blink-Brems-Schlussleuchte LED DI / Stop / Tail Light | BL BR S W SN R K SM DI ST TL RV FL RR NP SM | 24 V | 4/3/3 W | PMMA / PC/ ABS | Kabel 500 mm cable 500 mm | 0,30 kg | -20/+50°C IP 67 | 12 | E13-35099 |
| | 10.1043.600 BBS 115/24V | LED-Blink-Brems-Schlussleuchte LED DI / Stop / Tail Light | BL BR S W SN R K SM DI ST TL RV FL RR NP SM | 24 V | 4/3/3 W | PMMA / PC/ ABS | Kabel 2500 mm cable 2500 mm | 0,40 kg | -20/+50°C IP 67 | 8 | E13-35099 |
| | 13.3117.000 SNWS 115/12V | LED-Nebelschl.-Rückfahr-Schlussleu. LED Fog/ Reversing / Tail Light | BL BR S W SN R K SM DI ST TL RV FL RR NP SM | 12 V | 5/3/5 W | PMMA / PC/ ABS | Kabel 500 mm cable 500 mm | 0,30 kg | -20/+50°C IP 67 | 12 | E13-35099 E13-35862 |
| | 13.3117.500 SNWS 115/24V | LED-Nebelschl.-Rückfahr-Schlussleu. LED Fog/ Reversing / Tail Light | BL BR S W SN R K SM DI ST TL RV FL RR NP SM | 24 V | 5/3/5 W | PMMA / PC/ ABS | Kabel 500 mm cable 500 mm | 0,30 kg | -20/+50°C IP 67 | 12 | E13-35099 E13-35862 |
| | 13.3117.600 SNWS 115/24V | LED-Nebelschl.-Rückfahr-Schlussleu. LED Fog/ Reversing / Tail Light | BL BR S W SN R K SM DI ST TL RV FL RR NP SM | 24 V | 5/3/5 W | PMMA / PC/ ABS | Kabel 2500 mm cable 2500 mm | 0,40 kg | -20/+50°C IP 67 | 8 | E13-35099 E13-35862 |

Zubehör / Ersatzteile * Accessories / Spare parts

| | | | | | | | | | | | |
|--|-------------------------------------|--|---|------|----------|-----------------------------------|------------------------------------|---------|--------------------|---|-----|
| | 62.3001.002 LK 100b-1/12V | LED-Kontrollbox (Blinker) LED Control Device (DI) | Schaltschw/Threshold 25 mA (=const.) | 12 V | 2 x 21 W | Aluminium / PU schwarz - black | Kabel 2x1500 mm cable 2x1500 mm | 0,40 kg | -20/+50°C IP 67 | 1 | EMV |
| | 62.3002.012 LK 100-1/24V | LED-Kontrollbox (Blinker) LED Control Device (DI) | Schaltschw/Threshold 20 mA (=const.) | 24 V | 2 x 21 W | Aluminium / PU schwarz - black | Kabel 2x1500 mm cable 2x1500 mm | 0,40 kg | -20/+50°C IP 67 | 1 | EMV |

LED-LEUCHTEN-SYSTEM L780 * LED LIGHTING SYSTEM L780

Neuentwickelte Lichttechnik verfügbar als modulare Rundleuchtenserie mit dem Durchmesser von 95mm. Homogenes Lichtbild durch die besondere Oberfläche der Streuscheiben. In 12V als auch 24V Varianten erhältlich.

Latest lighting technology available as modular series of round shaped light with a diameter of 95mm. The special structure of the surface of the optical lens creates an homogeneous light pattern. Available in 12V or 24V variants.

Technische Daten * Technical Data

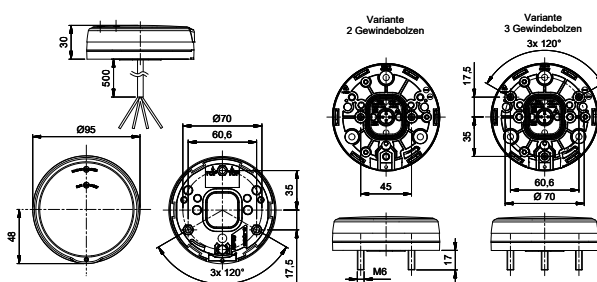

- LED-Multifunktionsleuchten mit Totalreflektionsoptik
- Aufbau-Montage mit Bajonett-System (alternativ mit Gewindebolzen)
- Montage und Demontage durch Inbusschlüssel Verriegelung
- 2 Dichtungen für optimale Wasserdichtigkeit
- Inkl. verdeckter Membran für thermodynamischen Ausgleich
- EMV Zulassung
- Blinker: mit LDC (LED-Defect-Contr.); kombinierb. mit LK Kontrollbox

- LED multifunction light with total-reflection optic
- surface mounting with bayonet joint (alternatively with bolts)
- quick assembly and disassembly through locking pin
- double sealed for optimal waterproofness
- incl. hidden membrane to balance thermodynamics
- EMC approval
- DI function: with LDC (LED-Defect-Control) for combination with LK control device

| Bild Picture | Art.-Nr. / No. Typ / Type | Beschreibung Description | Merkmale Features | Spann. Voltage | Leistung Power | Material / Farbe Material / Colour | Anschluss Connection | Gewicht Weight | IP / Temp. IP / Temp. | VP PU | Homolog. Approval |
|-----------------|--------------------------------------|---|----------------------|-------------------|-------------------|---|------------------------------|-------------------|--------------------------|----------|------------------------|
| | 10.0053.000 BBS 780/12V | LED-Blink-Brems-Schlussl. LED DI / Stop / Tail Light | | 12 V | 4 / 3 / 1 W | PC / PC-ABS rot, klar - red, clear | Kabel 500 mm cable 500 mm | 0,28 kg | -20/+50°C IP 67 | 12 | E13-34660 E13-34664 |
| | 10.0053.500 BBS 780/24V | LED-Blink-Brems-Schlussl. LED DI / Stop / Tail Light | | 24 V | 4 / 3 / 1 W | PC / PC-ABS rot, klar / red, clear | Kabel 500 mm cable 500 mm | 0,28 kg | -20/+50°C IP 67 | 12 | E13-34660 E13-34664 |
| | 10.0061.000 BRS 780/12V | LED-Brems-Schlussleuchte LED Stop / Tail Light | | 12 V | 3 / 1 W | PC / PC-ABS klar-schwarz / clear-black | Kabel 500 mm cable 500 mm | 0,28 kg | -20/+50°C IP 67 | 12 | E13-34664 |
| | 10.0061.500 BRS 780/24V | LED-Brems-Schlussleuchte LED Stop / Tail Light | | 24 V | 3 / 1 W | PC / PC-ABS klar-schwarz / clear-black | Kabel 500 mm cable 500 mm | 0,28 kg | -20/+50°C IP 67 | 12 | E13-34664 |
| | 13.1067.000 BL 780/12V | LED-Blinker / Kat. 2a LED DI / Cat. 2a | | 12 V | 3 W | PC / PC-ABS klar-schwarz / clear-black | Kabel 500 mm cable 500 mm | 0,28 kg | -20/+50°C IP 67 | 12 | E13-34661 E13-13971 |
| | auf Anfrage/on request BL 780/24V | LED-Blinker / Kat. 2a LED DI / Cat. 2a | | 24 V | 3 W | PC / PC-ABS klar-schwarz / clear-black | Kabel 500 mm cable 500 mm | 0,28 kg | -20/+50°C IP 67 | 12 | E13-34661 |
| | 13.3114.000 SNW 780/12V | LED-Nebelschluss / Rückf. LED Fog / Reversing Light | | 12V | 6W / 4W | PC / PC-ABS rot, klar - red, clear | Kabel 500 mm cable 500 mm | 0,28 kg | -20/+50°C IP 67 | 12 | E13-34809 E13-34808 |
| | 13.3114.500 SNW 780/24V | LED-Nebelschluss / Rückf. LED Fog / Reversing Light | | 24V | 6W / 5W | PC / PC-ABS rot, klar - red, clear | Kabel 500 mm cable 500 mm | 0,28 kg | -20/+50°C IP 67 | 12 | E13-34809 E13-34808 |
| | 13.3040.000 SN 780/12V | LED-Nebelschlussleuchte LED Fog Light | | 12 V | 6W | PC / PC-ABS klar - clear | Kabel 500 mm cable 500 mm | 0,28 kg | -20/+50°C IP 67 | 12 | E13-34809 |
| | 13.3040.500 SN 780/24V | LED-Nebelschlussleuchte LED Fog Light | | 24 V | 6W | PC / PC-ABS klar - clear | Kabel 500 mm cable 500 mm | 0,28 kg | -20/+50°C IP 67 | 12 | E13-34809 |
| | 13.3043.000 SNR 780/12V | LED-Nebelschluss-Rückstr. LED Fog / Reflex Reflector | | 12 V | 6W | PC / PC-ABS klar - clear | Kabel 500 mm cable 500 mm | 0,28 kg | -20/+50°C IP 67 | 12 | E13-34809 |
| | 13.3043.500 SNR 780/24V | LED-Nebelschluss-Rückstr. LED Fog / Reflex Reflector | | 24 V | 6W | PC / PC-ABS klar - clear | Kabel 500 mm cable 500 mm | 0,28 kg | -20/+50°C IP 67 | 12 | E13-34809 |
| | 13.6043.000 W 780/12V | LED-Rückfahrleuchte LED Reversing Light | | 12 V | 4W | PC / PC-ABS klar-schwarz / clear-black | Kabel 500 mm cable 500 mm | 0,28 kg | -20/+50°C IP 67 | 12 | E13-34810 |
| | 13.6043.500 W 780/24V | LED-Rückfahrleuchte LED Reversing Light | | 24 V | 4W | PC / PC-ABS klar-schwarz / clear-black | Kabel 500 mm cable 500 mm | 0,28 kg | -20/+50°C IP 67 | 12 | E13-34810 |
| | 13.6045.000 WR 780/12V | LED-Rückfahrleuchte-Rückstr. LED Reversing Light- Reflex refl. | | 12 V | 4W | PC / PC-ABS rot, klar - red, clear | Kabel 500 mm cable 500 mm | 0,28 kg | -20/+50°C IP 67 | 12 | E13-34810 |
| | 13.6045.500 WR 780/24V | LED-Rückfahrleuchte-Rückstr. LED Reversing Light- Reflex refl. | | 24 V | 4W | PC / PC-ABS rot, klar - red, clear | Kabel 500 mm cable 500 mm | 0,28 kg | -20/+50°C IP 67 | 12 | E13-34810 |

Zusatz-Information:
Additional Information: weitere Ausführungen auf Anfrage
further models on request

Zubehör / Ersatzteile * Accessories / Spare parts

| | | | | | | | | | | | |
|--|-------------------------------------|--|--|------|----------|-----------------------------------|----------------------------------|---------|--------------------|---|-----|
| | 62.3001.002 LK 100b-1/12V | LED-Kontrollbox (Blinker) LED Control Device (DI) | Schaltsw./Thresholt: 25 mA (I=const.) | 12 V | 2 x 21 W | Aluminium / PU schwarz - black | Kabel 2x1500mm cable 2x1500mm | 0,40 kg | -20/+50°C IP 67 | 1 | EMV |
| | 62.3002.012 LK 100-1/24V | LED-Kontrollbox (Blinker) LED Control Device (DI) | Schaltsw./Thresholt: 20 mA (I=const.) | 24 V | 2 x 21 W | Aluminium / PU schwarz - black | Kabel 2x1500mm cable 2x1500mm | 0,40 kg | -20/+50°C IP 67 | 1 | EMV |

LED-LEUCHTEN-SYSTEM L770 * LED LIGHTING SYSTEM L770

Neuentwickelte Lichttechnik verfügbar als modulare Rundleuchterserie mit dem Durchmesser von 65mm. Homogenes Lichtbild durch die besondere Oberfläche der Streuscheiben. Einfaches Befestigungskonzept: Eine am Fahrzeug angebrachte Adapterplatte ermöglicht eine Montage der Leuchte von außen mit einem einzigen Handgriff. (Optional: Stehbolzen). In 12V als auch 24V Varianten erhältlich.

Latest lighting technology available as modular series of round shaped light with a diameter of 65mm. The special structure of the surface of the optical lense creates an homogeneous light pattern. Quick & Easy fixture: an adapter plate screwed on the vehicle allows to mount the light from the exterior (optional: stud bolts). Available in 12V or 24V variants.

Merkmale * Features



- Charakteristisches Nachtdesign und innovative Technik
- characteristic night design and innovative technology

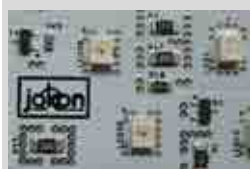

- Marken LEDs von Osram für lange Lebensdauer
- High-Grade LEDs from Osram for long life time



- Innovatives Befestigungskonzept
- innovative fixation concept



- Mit Microfaser-Membran für optimalen thermodyn. Ausgleich
- with microfibre membrane for optimal thermodynamic balance



- Kombinierbar mit LED-Kontrollbox für Blinkerausfallkontrolle
- combination with device for LED failure control of direction indicator

Technische Daten * Technical Data

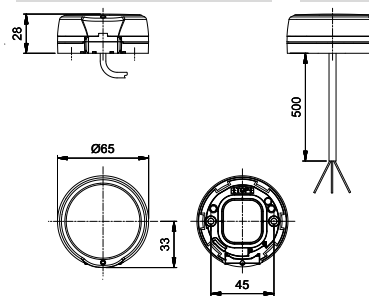

- LED-Multifunktionsleuchten mit Totalreflektionsoptik
- Aufbau-Montage mit Bajonett-System (alternativ mit Gewindebolzen)
- Montage und Demontage durch Inbusschlüssel Verriegelung
- 2 Dichtungen für optimale Wasserdichtigkeit
- Inkl. verdeckter Membran für thermodynamischen Ausgleich
- EMV Zulassung
- Blinker: mit LDC (LED-Defect-Contr.); kombinierb. mit LK Kontrollbox

- LED multifunction light with total-reflection optic
- surface mounting with bayonet joint (alternatively with bolts)
- quick assembly and disassembly through locking pin
- double sealed for optimal waterproofness
- incl. hidden membrane to balance thermodynamics
- EMC approval
- DI function: with LDC (LED-Defect-Control) for combination with LK control device

| Bild Picture | Art.-Nr. / No. Typ / Type | Beschreibung Description | Merkmale Features | Spann. Voltage | Leistung Power | Material / Farbe Material / Colour | Anschluss Connection | Gewicht Weight | IP / Temp. IP / Temp. | VP PU | Homolog. Approval |
|-----------------|-----------------------------------|---|--|-------------------|-------------------|---------------------------------------|------------------------------|-------------------|--------------------------|----------|------------------------|
| | 10.0052.000 BRS 770/12V | LED-Brems-Schlussleuchte LED Stop / Tail Light | • BL BR S W SN R K SM • DI ST TL RV FL FR NP SM | 12 V | 3 / 1 W | PC / PC-ABS rot, klar / red-clear | Kabel 500 mm cable 500 mm | 0,28 kg | -20/+50°C IP 67 | 12 | E13-34663 |
| | 10.0052.500 BRS 770/24V | LED-Brems-Schlussleuchte LED Stop / Tail Light | • BL BR S W SN R K SM • DI ST TL RV FL FR NP SM | 24 V | 3 / 1 W | PC / PC-ABS rot, klar / red-clear | Kabel 500 mm cable 500 mm | 0,28 kg | -20/+50°C IP 67 | 12 | E13-34663 |
| | 10.0052.300 BRS 770/12V | LED-Brems-Schlussleuchte LED Stop / Tail Light | • BL BR S W SN R K SM • DI ST TL RV FL FR NP SM | 12 V | 3 / 1 W | PC / PC-ABS klar / clear | Kabel 500 mm cable 500 mm | 0,28 kg | -20/+50°C IP 67 | 12 | E13-34663 |
| | 10.0052.800 BRS 770/24V | LED-Brems-Schlussleuchte LED Stop / Tail Light | • BL BR S W SN R K SM • DI ST TL RV FL FR NP SM | 24 V | 3 / 1 W | PC / PC-ABS klar / clear | Kabel 500 mm cable 500 mm | 0,28 kg | -20/+50°C IP 67 | 12 | E13-34663 |
| | 13.1066.000 BL 770/12V | LED-Blinker / Kat. 2a LED DI / Cat. 2a | • BL BR S W SN R K SM • DI ST TL RV FL FR NP SM | 12 V | 2 W | PC / PC-ABS klar / clear | Kabel 500 mm cable 500 mm | 0,28 kg | -20/+50°C IP 67 | 12 | E13-34660 E13-14418 |
| | 13.1066.500 BL 770/24V | LED-Blinker / Kat. 2a LED DI / Cat. 2a | • BL BR S W SN R K SM • DI ST TL RV FL FR NP SM | 24 V | 4 W | PC / PC-ABS klar / clear | Kabel 500 mm cable 500 mm | 0,28 kg | -20/+50°C IP 67 | 12 | E13-34660 E13-14418 |
| | 13.3039.000 SN 770/12V | LED-Nebelschlussleuchte LED Fog Light | • BL BR S W SN R K SM • DI ST TL RV FL FR NP SM | 12 V | 3 W | PC / PC-ABS klar / clear | Kabel 500 mm cable 500 mm | 0,28 kg | -20/+50°C IP 67 | 12 | E13-34807 E13-14418 |
| | 13.3039.500 SN 770/24V | LED-Nebelschlussleuchte LED Fog Light | • BL BR S W SN R K SM • DI ST TL RV FL FR NP SM | 24 V | 5 W | PC / PC-ABS klar / clear | Kabel 500 mm cable 500 mm | 0,28 kg | -20/+50°C IP 67 | 12 | E13-34807 E13-14418 |
| | 13.6042.000 W 770/12V | LED-Rückfahrleuchte LED Reversing Light | • BL BR S W SN R K SM • DI ST TL RV FL FR NP SM | 12 V | 4 W | PC / PC-ABS klar / clear | Kabel 500 mm cable 500 mm | 0,28 kg | -20/+50°C IP 67 | 12 | E13-34808 |
| | 13.6042.500 W 770/24V | LED-Rückfahrleuchte LED Reversing Light | • BL BR S W SN R K SM • DI ST TL RV FL FR NP SM | 24 V | 6 W | PC / PC-ABS klar / clear | Kabel 500 mm cable 500 mm | 0,28 kg | -20/+50°C IP 67 | 12 | E13-34808 |
| | auf Anfrage/on request R 770 | Rückstrahler Reflex Reflector | | | | PC / PC-ABS rot / red | | | | | E1-4381 |

Zubehör / Ersatzteile * Accessories / Spare parts

| | | | | | | | | | | | |
|--|-------------------------------------|--|---|------|----------|-----------------------------------|------------------------------------|---------|--------------------|---|-----|
| | 62.3001.002 LK 100b-1/12V | LED-Kontrollbox (Blinker) LED Control Device (DI) | Schaltsw./Threshold 25 mA (I=const.) | 12 V | 2 x 21 W | Aluminium / PU schwarz - black | Kabel 2x1500 mm cable 2x1500 mm | 0,40 kg | -20/+50°C IP 67 | 1 | EMV |
| | 62.3002.012 LK 100-1/24V | LED-Kontrollbox (Blinker) LED Control Device (DI) | Schaltsw./Threshold 20 mA (I=const.) | 24 V | 2 x 21 W | Aluminium / PU schwarz - black | Kabel 2x1500 mm cable 2x1500 mm | 0,40 kg | -20/+50°C IP 67 | 1 | EMV |

LED-LEUCHTEN-SYSTEM 730 * LED LIGHTING SYSTEM 730

Die LED-Leuchten der Serie 730/735 sind anschlussfertig, wasserdicht vergossen und verfügen über ein Anschlusskabel von 500 mm Länge. Die Leuchten sind für den Einbau vorgesehen, sind aber wegen ihrer geringen Einbautiefe (33,5 mm) auch für den Aufbau geeignet.
 LED Lights type 730/735 are ready for plug-in, they are sealed in a waterproof manner and are equipped with a connecting cable of 500 mm. They are used for flush fitting, but because of their small installation depth (33,5 mm) they can be used for surface mounting as well.

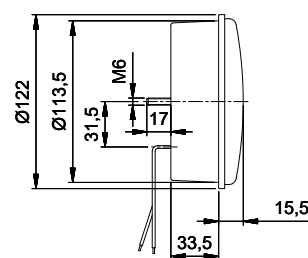
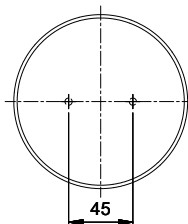

· Wasserdicht vergossen und anschlussfertig
 · Einbau- oder Aufbau montage

· sealed in a waterproof manner and ready for plug-in
 · flush fitting or surface mounting

| Bild Picture | Art.-Nr. / No. Typ / Type | Beschreibung Description | Merkmale Features | Spann. Voltage | Leistung Power | Material / Farbe Material / Colour | Anschluss Connection | Gewicht Weight | IP / Temp. IP / Temp. | VP PU | Homolog. Approval |
|---|------------------------------------|---|--|-------------------|-------------------|---------------------------------------|----------------------------------|-------------------|--------------------------|----------|----------------------|
| | 10.0050.000 BBS 730b/12V | LED-Blink-Brems-Schluss. LED DI / Stop / Tail Light | | 12 V | 4 / 3 / 1 W | PMMA / ABS rot, klar - red, clear | Kabel 500 mm cable 500 mm | 0,22 kg | IP 67 | 10 | E1-4231 |
| | 10.0051.000 BBS 730b/24V | LED-Blink-Brems-Schluss. LED DI / Stop / Tail Light | | 24 V | 4 / 3 / 1 W | PMMA / ABS rot, klar/ red-clear | Kabel 500 mm cable 500 mm | 0,22 kg | IP 67 | 10 | E1-4231 |
| | 10.0016.000 BRS 730/12V | LED-Brems-Schlussleuchte LED Stop / Tail Light | | 12 V | 3 / 0,5 W | PMMA / ABS rot - red | Kabel 500 mm cable 500 mm | 0,22 kg | IP 67 | 10 | E2-06014 |
| | 10.0017.000 BRS 730/24V | LED-Brems-Schlussleuchte LED Stop / Tail Light | | 24 V | 3 / 0,5 W | PMMA / ABS rot - red | Kabel 500 mm cable 500 mm | 0,22 kg | IP 67 | 10 | E2-06014 |
| | 13.1024.000 BL 730/12V | LED-Blinker / Kat. 2a LED DI / Cat. 2a | | 12 V | 3 W | PMMA / ABS gelb - yellow | Kabel 500 mm cable 500 mm | 0,22 kg | IP 67 | 10 | E2-06015 |
| | 13.1025.000 BL 730/24V | LED-Blinker / Kat. 2a LED DI / Cat. 2a | | 24 V | 3 W | PMMA / ABS gelb - yellow | Kabel 500 mm cable 500 mm | 0,22 kg | IP 67 | 10 | E2-06015 |
| | 13.3017.000 SN 730/12V | LED-Nebelschlussleuchte LED Fog Light | | 12 V | 4 W | PMMA / ABS rot - red | Kabel 500 mm cable 500 mm | 0,22 kg | IP 67 | 10 | E2-06017 |
| | 13.3018.000 SN 730/24V | LED-Nebelschlussleuchte LED Fog Light | | 24 V | 4 W | PMMA / ABS rot - red | Kabel 500 mm cable 500 mm | 0,22 kg | IP 67 | 10 | E2-06017 |
| | 13.3020.000 SNR 730/12V | LED-Nebelschluss/ Rückstr. LED Fog Light / refl. | | 12 V | 4 W | PMMA / ABS rot - red | Kabel 500 mm cable 500 mm | 0,22 kg | IP 67 | 10 | E2-06012 |
| | 13.3021.000 SNR 730/24V | LED-Nebelschluss/ Rückstr. LED Fog Light / refl. | | 24 V | 4 W | PMMA / ABS rot - red | Kabel 500 mm cable 500 mm | 0,22 kg | IP 67 | 10 | E2-06012 |
| | 13.6015.000 W 730/12V | LED-Rückfahrleuchte LED Reversing Light | | 12 V | 3 W | PMMA / ABS klar - clear | Kabel 500 mm cable 500 mm | 0,22 kg | IP 67 | 10 | E2-06016 |
| | 13.6016.000 W 730/24V | LED-Rückfahrleuchte LED Reversing Light | | 24 V | 3 W | PMMA / ABS klar / clear | Kabel 500 mm cable 500 mm | 0,22 kg | IP 67 | 10 | E2-06016 |
| | 13.6018.000 WR 730/12V | LED-Rückfahr. / Rückstr. LED Reversing Light / refl. | | 12 V | 3 W | PMMA / ABS klar, rot - clear, red | Kabel 500 mm cable 500 mm | 0,22 kg | IP 67 | 10 | E2-06013 |
| | 13.6019.000 WR 730/24V | LED-Rückfahr. / Rückstr. LED Reversing Light / refl. | | 24 V | 3 W | PMMA / ABS klar, rot - clear, red | Kabel 500 mm cable 500 mm | 0,22 kg | IP 67 | 10 | E2-06013 |
| | 13.3110.000 SNW 730/12V | LED-Nebelschluss / Rückf. LED Fog / Reversing Light | | 12 V | 3 / 4 W | PMMA / ABS klar / clear | Kabel 500 mm cable 500 mm | 0,22 kg | IP 67 | 10 | E2-06046 |
| | 13.3111.000 SNW 730/24V | LED-Nebelschluss / Rückf. LED Fog / Reversing Light | | 24 V | 3 / 4 W | PMMA / ABS klar / clear | Kabel 500 mm cable 500 mm | 0,22 kg | IP 67 | 10 | E2-06046 |
| Zubehör / Ersatzteile * Accessories / Spare parts | | | | | | | | | | | |
| | 62.3001.032 LK 100-3/12V | LED-Kontrollbox (Blinker) LED Control Device (DI) | Schaltstrom/Threshold 45 mA (I=const.) | 12 V | 2 x 21 W | Aluminium / PU schwarz - black | Kabel 2x1500mm cable 2x1500mm | 0,40 kg | -20/+50°C IP 67 | 10 | EMV / EMC |
| Zusatz-Information: Additional Information: | | | geeignet für Leuchte: BBS 730/12 2a suitable for light: BBS 730/12 2a | | | | | | | | |
| | 62.3002.022 LK 100-2/24V | LED-Kontrollbox (Blinker) LED Control Device (DI) | Schaltstrom/Threshold 50 mA bei 24V | 24 V | 2 x 21 W | Aluminium / PU schwarz - black | Kabel 2x1500mm cable 2x1500mm | 0,40 kg | -20/+50°C IP 67 | 1 | EMV / EMC |
| Zusatz-Information: Additional Information: | | | geeignet für Leuchte: BBS 730/24V; BL 730/24V 2a suitable for light: BBS 730/24V; BL 730/24V 2a | | | | | | | | |

LED-LEUCHTEN-SYSTEM 726 * LED LIGHTING SYSTEM 726





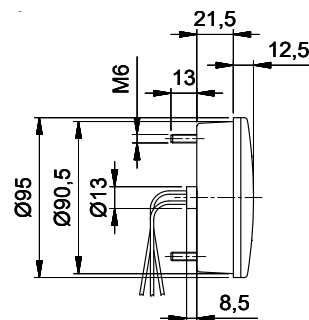
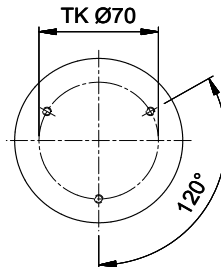





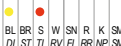

Die LED-Leuchten sind anschlussfertig und wasserdicht vergossen und verfügen über ein Anschlusskabel von 500 mm Länge. Die Leuchten sind für den Einbau vorgesehen, sind aber wegen ihrer geringen Einbautiefe (21,5 mm) auch für den Aufbau geeignet.

These LED Lights are ready for plug-in, they are sealed in a waterproof manner and are equipped with a connecting cable of 500 mm. These Lights are used for flush fitting, but because of their small installation depth (21,5 mm) they can be used for surface mounting as well.

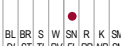

· Wasserdicht vergossen und anschlussfertig
· Einbau- oder Aufbaumontage

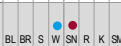
· sealed in a waterproof manner and ready for plug-in
· flush fitting or surface mounting

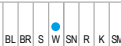
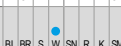
| Bild Picture | Art.-Nr. / No. Typ / Type | Beschreibung Description | Merkmale Features | Spann. Voltage | Leistung Power | Material / Farbe Material / Colour | Anschluss Connection | Gewicht Weight | IP / Temp. IP / Temp. | VP PU | Homolog. Approval |
|---|-----------------------------------|---|---|-------------------|-------------------|---------------------------------------|------------------------------|-------------------|--------------------------|----------|----------------------|
|  | 10.0032.500 BBS 726/12V | LED-Blink-Brems-Schlussl. LED DI / Stop / Tail Light |  | 12 V | 3 / 4 / 0,5 W | PMMA / ABS klar - clear | Kabel 500 mm cable 500 mm | 0,15 kg | IP 67 | 10 | E2-07013 |
| | 10.0033.500 BBS 726/24V | LED-Blink-Brems-Schlussl. LED DI / Stop / Tail Light |  | 24 V | 3 / 4 / 0,5 W | PMMA / ABS klar - clear | Kabel 500 mm cable 500 mm | 0,15 kg | IP 67 | 10 | E2-07013 |
|  | 10.0024.500 BLS 726/12V | LED-Blink-Schlussleuchte LED DI / Tail Light |  | 12 V | 3 / 0,5 W | PMMA / ABS klar - clear | Kabel 500 mm cable 500 mm | 0,15 kg | IP 67 | 10 | E2-06054 |
| | 10.0025.500 BLS 726/24V | LED-Blink-Schlussleuchte LED DI / Tail Light |  | 24 V | 3 / 0,5 W | PMMA / ABS klar - clear | Kabel 500 mm cable 500 mm | 0,15 kg | IP 67 | 10 | E2-06054 |
|  | 10.0022.500 BRS 726/12V | LED-Brems-Schlussleuchte LED Stop / Tail Light |  | 12 V | 4 / 0,5 W | PMMA / ABS klar - clear | Kabel 500 mm cable 500 mm | 0,15 kg | IP 67 | 10 | E2-06053 |
| | 10.0023.500 BRS 726/24V | LED-Brems-Schlussleuchte LED Stop / Tail Light |  | 24 V | 4 / 0,5 W | PMMA / ABS klar - clear | Kabel 500 mm cable 500 mm | 0,15 kg | IP 67 | 10 | E2-06053 |
|  | 13.1033.000 BL 726/12V | LED-Blinkleuchte / Kat. 1+2a LED DI / Cat. 1+2a |  | 12 V | 3 W | PMMA / ABS klar - clear | Kabel 500 mm cable 500 mm | 0,15 kg | IP 67 | 10 | E2-06055 |
| | 13.1034.000 BL 726/24V | LED-Blinkleuchte / Kat. 1+ 2a LED DI / Cat. 1+2a |  | 24 V | 3 W | PMMA / ABS klar - clear | Kabel 500 mm cable 500 mm | 0,15 kg | IP 67 | 10 | E2-06055 |
|  | 13.3026.500 SN 726/12V | LED-Nebelschlussleuchte LED Fog Light |  | 12 V | 4 W | PMMA / ABS klar - clear | Kabel 500 mm cable 500 mm | 0,15 kg | IP 67 | 10 | E2-06056 |
| | 13.3027.500 SN 726/24V | LED-Nebelschlussleuchte LED Fog Light |  | 24 V | 4 W | PMMA / ABS klar - clear | Kabel 500 mm cable 500 mm | 0,15 kg | IP 67 | 10 | E2-06056 |
|  | 13.3104.500 SNW 726/12V | LED-Nebelschluss / Rückf LED Fog / Reversing Light |  | 12 V | 4 / 3 W | PMMA / ABS klar - clear | Kabel 500 mm cable 500 mm | 0,15 kg | IP 67 | 10 | E2-07012 |
| | 13.3105.600 SNW 726/24V | LED-Nebelschluss / Rückf LED Fog / Reversing Light |  | 24 V | 4 / 3 W | PMMA / ABS klar - clear | Kabel 500 mm cable 500 mm | 0,15 kg | IP 67 | 10 | E2-07012 |
|  | 13.6024.000 W 726/12V | LED-Rückfahrleuchte LED Reversing Light |  | 12 V | 3 W | PMMA / ABS klar - clear | Kabel 500 mm cable 500 mm | 0,15 kg | IP 67 | 10 | E2-06052 |
| | 13.6025.000 W 726/24V | LED-Rückfahrleuchte LED Reversing Light |  | 24 V | 3 W | PMMA / ABS klar - clear | Kabel 500 mm cable 500 mm | 0,15 kg | IP 67 | 10 | E2-06052 |

Zubehör / Ersatzteile * Accessories / Spare parts

| | | | | | | | | | | | |
|---|------------------------------------|--|---|------|----------|-----------------------------------|----------------------------------|---------|--------------------|----|------------------|
|  | 62.3001.032 LK 100-3/12V | LED-Kontrollbox (Blinker) LED Control Device (DI) | Schaltstrom/Threshold 45 mA (I=const.) | 12 V | 2 x 21 W | Aluminium / PU schwarz - black | Kabel 2x1500mm cable 2x1500mm | 0,40 kg | -20/+50°C IP 67 | 10 | EMV / EMC E/5 |
|---|------------------------------------|--|---|------|----------|-----------------------------------|----------------------------------|---------|--------------------|----|------------------|

Zusatz-Information:
Additional Information:

geeignet für Leuchte: BL 726/12V
suitable for light: BL 726/12V

LED-LEUCHTEN-SYSTEM 725 * LED LIGHTING SYSTEM 725

Die Leuchten der Serie 725 sind anschlussfertig, wasserdicht vergossen und verfügen über ein Anschlusskabel von 500 mm. Sie sind mittels einem in verschiedenen Farben lieferbaren Zierring auf einen Durchmesser von 122 mm vergrößerbar. Die Leuchten sind für den Einbau vorgesehen, sind aber wegen ihrer geringen Einbautiefe auch für den Aufbau geeignet.

LED Lights type 725 are ready for plug-in, they are sealed in a waterproof manner and are equipped with a connecting cable of 500 mm. They can be extended by a decoration rim to a diameter of 122 mm available in different colours. These lights are used for flush fitting, but because of their small installation depth they can be used for surface mounting as well.

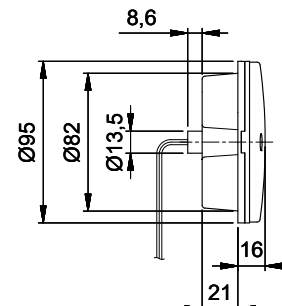
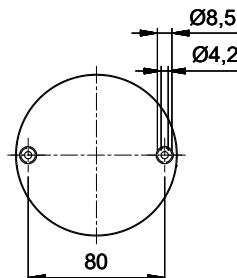

- Wasserdicht vergossen und anschlussfertig
- Einbau- oder Aufbau montage

- sealed in a waterproof manner and ready for plug-in
- flush fitting or surface mounting

| Bild Picture | Art.-Nr. / No. Typ / Type | Beschreibung Description | Merkmale Features | Spann. Voltage | Leistung Power | Material / Farbe Material / Colour | Anschluss Connection | Gewicht Weight | IP / Temp. IP / Temp. | VP PU | Homolog. Approval | | | | | | | | | | | | | | | | | | | | | | | | | | | | | | | | | | | | |
|---|---|---|---|-------------------|-------------------|---------------------------------------|-------------------------|-------------------|--------------------------|----------|----------------------|--|--|--|----|----|----|---|----|----|---|----|----|--|--|--|----|----|----|----|----|----|----|----|----|--|--|--|------|---------------|--------------------------------------|--------------------------------------|------------------------------|---------|-------|----------|----------|
|  | 10.0034.000 BBS 725/12V | LED-Blink-Brems-Schlussl. LED DI / Stop / Tail Light | <table border="1"><tr><td>●</td><td>●</td><td></td><td></td><td></td><td></td><td></td><td></td><td></td><td></td><td></td><td></td></tr><tr><td>BL</td><td>BR</td><td>S</td><td>W</td><td>SN</td><td>R</td><td>K</td><td>SM</td><td></td><td></td><td></td><td></td></tr><tr><td>DI</td><td>ST</td><td>TL</td><td>RV</td><td>FL</td><td>FR</td><td>NP</td><td>SM</td><td></td><td></td><td></td><td></td></tr></table> | ● | ● | | | | | | | | | | | BL | BR | S | W | SN | R | K | SM | | | | | DI | ST | TL | RV | FL | FR | NP | SM | | | | | 12 V | 3 / 3 / 0,3 W | PMMA / ABS rot, klar - red, clear | Kabel 500 mm cable 500 mm | 0,13 kg | IP 67 | 10 | E2-07043 |
| | ● | ● | | | | | | | | | | | | | | | | | | | | | | | | | | | | | | | | | | | | | | | | | | | | | |
| BL | BR | S | W | SN | R | K | SM | | | | | | | | | | | | | | | | | | | | | | | | | | | | | | | | | | | | | | | | |
| DI | ST | TL | RV | FL | FR | NP | SM | | | | | | | | | | | | | | | | | | | | | | | | | | | | | | | | | | | | | | | | |
| 10.0035.000 BBS 725/24V | LED-Blink-Brems-Schlussl. LED DI / Stop / Tail Light | <table border="1"><tr><td>●</td><td>●</td><td></td><td></td><td></td><td></td><td></td><td></td><td></td><td></td><td></td><td></td></tr><tr><td>BL</td><td>BR</td><td>S</td><td>W</td><td>SN</td><td>R</td><td>K</td><td>SM</td><td></td><td></td><td></td><td></td></tr><tr><td>DI</td><td>ST</td><td>TL</td><td>RV</td><td>FL</td><td>FR</td><td>NP</td><td>SM</td><td></td><td></td><td></td><td></td></tr></table> | ● | ● | | | | | | | | | | | BL | BR | S | W | SN | R | K | SM | | | | | DI | ST | TL | RV | FL | FR | NP | SM | | | | | 24 V | 3 / 3 / 0,3 W | PMMA / ABS rot, klar - red, clear | Kabel 500 mm cable 500 mm | 0,13 kg | IP 67 | 10 | E2-07043 | |
| ● | ● | | | | | | | | | | | | | | | | | | | | | | | | | | | | | | | | | | | | | | | | | | | | | | |
| BL | BR | S | W | SN | R | K | SM | | | | | | | | | | | | | | | | | | | | | | | | | | | | | | | | | | | | | | | | |
| DI | ST | TL | RV | FL | FR | NP | SM | | | | | | | | | | | | | | | | | | | | | | | | | | | | | | | | | | | | | | | | |
|  | 10.0038.000 BLS 725/12V | LED-Blink-Schlussleuchte LED DI / Tail Light | <table border="1"><tr><td>●</td><td></td><td></td><td></td><td></td><td></td><td></td><td></td><td></td><td></td><td></td><td></td></tr><tr><td>BL</td><td>BR</td><td>S</td><td>W</td><td>SN</td><td>R</td><td>K</td><td>SM</td><td></td><td></td><td></td><td></td></tr><tr><td>DI</td><td>ST</td><td>TL</td><td>RV</td><td>FL</td><td>FR</td><td>NP</td><td>SM</td><td></td><td></td><td></td><td></td></tr></table> | ● | | | | | | | | | | | | BL | BR | S | W | SN | R | K | SM | | | | | DI | ST | TL | RV | FL | FR | NP | SM | | | | | 12 V | 3 / 0,3 W | PMMA / ABS rot, klar - red, clear | Kabel 500 mm cable 500 mm | 0,13 kg | IP 67 | 10 | E2-07046 |
| | ● | | | | | | | | | | | | | | | | | | | | | | | | | | | | | | | | | | | | | | | | | | | | | | |
| BL | BR | S | W | SN | R | K | SM | | | | | | | | | | | | | | | | | | | | | | | | | | | | | | | | | | | | | | | | |
| DI | ST | TL | RV | FL | FR | NP | SM | | | | | | | | | | | | | | | | | | | | | | | | | | | | | | | | | | | | | | | | |
| 10.0039.000 BLS 725/24V | LED-Blink-Schlussleuchte LED DI / Tail Light | <table border="1"><tr><td>●</td><td></td><td></td><td></td><td></td><td></td><td></td><td></td><td></td><td></td><td></td><td></td></tr><tr><td>BL</td><td>BR</td><td>S</td><td>W</td><td>SN</td><td>R</td><td>K</td><td>SM</td><td></td><td></td><td></td><td></td></tr><tr><td>DI</td><td>ST</td><td>TL</td><td>RV</td><td>FL</td><td>FR</td><td>NP</td><td>SM</td><td></td><td></td><td></td><td></td></tr></table> | ● | | | | | | | | | | | | BL | BR | S | W | SN | R | K | SM | | | | | DI | ST | TL | RV | FL | FR | NP | SM | | | | | 24 V | 3 / 0,3 W | PMMA / ABS rot, klar - red, clear | Kabel 500 mm cable 500 mm | 0,13 kg | IP 67 | 10 | E2-07046 | |
| ● | | | | | | | | | | | | | | | | | | | | | | | | | | | | | | | | | | | | | | | | | | | | | | | |
| BL | BR | S | W | SN | R | K | SM | | | | | | | | | | | | | | | | | | | | | | | | | | | | | | | | | | | | | | | | |
| DI | ST | TL | RV | FL | FR | NP | SM | | | | | | | | | | | | | | | | | | | | | | | | | | | | | | | | | | | | | | | | |
|  | 10.0036.000 BRS 725/12V | LED-Brems-Schlussleuchte LED Stop / Tail Light | <table border="1"><tr><td>●</td><td>●</td><td></td><td></td><td></td><td></td><td></td><td></td><td></td><td></td><td></td><td></td></tr><tr><td>BL</td><td>BR</td><td>S</td><td>W</td><td>SN</td><td>R</td><td>K</td><td>SM</td><td></td><td></td><td></td><td></td></tr><tr><td>DI</td><td>ST</td><td>TL</td><td>RV</td><td>FL</td><td>FR</td><td>NP</td><td>SM</td><td></td><td></td><td></td><td></td></tr></table> | ● | ● | | | | | | | | | | | BL | BR | S | W | SN | R | K | SM | | | | | DI | ST | TL | RV | FL | FR | NP | SM | | | | | 12 V | 4 / 0,3 W | PMMA / ABS rot - red | Kabel 500 mm cable 500 mm | 0,13 kg | IP 67 | 10 | E2-07044 |
| | ● | ● | | | | | | | | | | | | | | | | | | | | | | | | | | | | | | | | | | | | | | | | | | | | | |
| BL | BR | S | W | SN | R | K | SM | | | | | | | | | | | | | | | | | | | | | | | | | | | | | | | | | | | | | | | | |
| DI | ST | TL | RV | FL | FR | NP | SM | | | | | | | | | | | | | | | | | | | | | | | | | | | | | | | | | | | | | | | | |
| 10.0037.000 BRS 725/24V | LED-Brems-Schlussleuchte LED Stop / Tail Light | <table border="1"><tr><td>●</td><td>●</td><td></td><td></td><td></td><td></td><td></td><td></td><td></td><td></td><td></td><td></td></tr><tr><td>BL</td><td>BR</td><td>S</td><td>W</td><td>SN</td><td>R</td><td>K</td><td>SM</td><td></td><td></td><td></td><td></td></tr><tr><td>DI</td><td>ST</td><td>TL</td><td>RV</td><td>FL</td><td>FR</td><td>NP</td><td>SM</td><td></td><td></td><td></td><td></td></tr></table> | ● | ● | | | | | | | | | | | BL | BR | S | W | SN | R | K | SM | | | | | DI | ST | TL | RV | FL | FR | NP | SM | | | | | 24 V | 4 / 0,3 W | PMMA / ABS rot - red | Kabel 500 mm cable 500 mm | 0,13 kg | IP 67 | 10 | E2-07044 | |
| ● | ● | | | | | | | | | | | | | | | | | | | | | | | | | | | | | | | | | | | | | | | | | | | | | | |
| BL | BR | S | W | SN | R | K | SM | | | | | | | | | | | | | | | | | | | | | | | | | | | | | | | | | | | | | | | | |
| DI | ST | TL | RV | FL | FR | NP | SM | | | | | | | | | | | | | | | | | | | | | | | | | | | | | | | | | | | | | | | | |
|  | 13.1040.000 BL 725/12V | LED-Blinkleuchte / Kat. 2a LED DI / Cat. 2a | <table border="1"><tr><td>●</td><td></td><td></td><td></td><td></td><td></td><td></td><td></td><td></td><td></td><td></td><td></td></tr><tr><td>BL</td><td>BR</td><td>S</td><td>W</td><td>SN</td><td>R</td><td>K</td><td>SM</td><td></td><td></td><td></td><td></td></tr><tr><td>DI</td><td>ST</td><td>TL</td><td>RV</td><td>FL</td><td>FR</td><td>NP</td><td>SM</td><td></td><td></td><td></td><td></td></tr></table> | ● | | | | | | | | | | | | BL | BR | S | W | SN | R | K | SM | | | | | DI | ST | TL | RV | FL | FR | NP | SM | | | | | 12 V | 3 W | PMMA / ABS klar - clear | Kabel 500 mm cable 500 mm | 0,13 kg | IP 67 | 10 | E2-07045 |
| | ● | | | | | | | | | | | | | | | | | | | | | | | | | | | | | | | | | | | | | | | | | | | | | | |
| BL | BR | S | W | SN | R | K | SM | | | | | | | | | | | | | | | | | | | | | | | | | | | | | | | | | | | | | | | | |
| DI | ST | TL | RV | FL | FR | NP | SM | | | | | | | | | | | | | | | | | | | | | | | | | | | | | | | | | | | | | | | | |
| 13.1040.500 BL 725/24V | LED-Blinkleuchte / Kat. 2a LED DI / Cat. 2a | <table border="1"><tr><td>●</td><td></td><td></td><td></td><td></td><td></td><td></td><td></td><td></td><td></td><td></td><td></td></tr><tr><td>BL</td><td>BR</td><td>S</td><td>W</td><td>SN</td><td>R</td><td>K</td><td>SM</td><td></td><td></td><td></td><td></td></tr><tr><td>DI</td><td>ST</td><td>TL</td><td>RV</td><td>FL</td><td>FR</td><td>NP</td><td>SM</td><td></td><td></td><td></td><td></td></tr></table> | ● | | | | | | | | | | | | BL | BR | S | W | SN | R | K | SM | | | | | DI | ST | TL | RV | FL | FR | NP | SM | | | | | 24 V | 3 W | PMMA / ABS klar - clear | Kabel 500 mm cable 500 mm | 0,13 kg | IP 67 | 10 | E2-07045 | |
| ● | | | | | | | | | | | | | | | | | | | | | | | | | | | | | | | | | | | | | | | | | | | | | | | |
| BL | BR | S | W | SN | R | K | SM | | | | | | | | | | | | | | | | | | | | | | | | | | | | | | | | | | | | | | | | |
| DI | ST | TL | RV | FL | FR | NP | SM | | | | | | | | | | | | | | | | | | | | | | | | | | | | | | | | | | | | | | | | |
|  | 13.3030.000 SN 725/12V | LED-Nebelschlussleuchte LED Fog Light | <table border="1"><tr><td></td><td></td><td>●</td><td></td><td></td><td></td><td></td><td></td><td></td><td></td><td></td><td></td></tr><tr><td>BL</td><td>BR</td><td>S</td><td>W</td><td>SN</td><td>R</td><td>K</td><td>SM</td><td></td><td></td><td></td><td></td></tr><tr><td>DI</td><td>ST</td><td>TL</td><td>RV</td><td>FL</td><td>FR</td><td>NP</td><td>SM</td><td></td><td></td><td></td><td></td></tr></table> | | | ● | | | | | | | | | | BL | BR | S | W | SN | R | K | SM | | | | | DI | ST | TL | RV | FL | FR | NP | SM | | | | | 12 V | 3 W | PMMA / ABS rot - red | Kabel 500 mm cable 500 mm | 0,13 kg | IP 67 | 10 | E2-07047 |
| | | | ● | | | | | | | | | | | | | | | | | | | | | | | | | | | | | | | | | | | | | | | | | | | | |
| BL | BR | S | W | SN | R | K | SM | | | | | | | | | | | | | | | | | | | | | | | | | | | | | | | | | | | | | | | | |
| DI | ST | TL | RV | FL | FR | NP | SM | | | | | | | | | | | | | | | | | | | | | | | | | | | | | | | | | | | | | | | | |
| 13.3031.000 SN 725/24V | LED-Nebelschlussleuchte LED Fog Light | <table border="1"><tr><td></td><td></td><td>●</td><td></td><td></td><td></td><td></td><td></td><td></td><td></td><td></td><td></td></tr><tr><td>BL</td><td>BR</td><td>S</td><td>W</td><td>SN</td><td>R</td><td>K</td><td>SM</td><td></td><td></td><td></td><td></td></tr><tr><td>DI</td><td>ST</td><td>TL</td><td>RV</td><td>FL</td><td>FR</td><td>NP</td><td>SM</td><td></td><td></td><td></td><td></td></tr></table> | | | ● | | | | | | | | | | BL | BR | S | W | SN | R | K | SM | | | | | DI | ST | TL | RV | FL | FR | NP | SM | | | | | 24 V | 4 W | PMMA / ABS rot - red | Kabel 500 mm cable 500 mm | 0,13 kg | IP 67 | 10 | E2-07047 | |
| | | ● | | | | | | | | | | | | | | | | | | | | | | | | | | | | | | | | | | | | | | | | | | | | | |
| BL | BR | S | W | SN | R | K | SM | | | | | | | | | | | | | | | | | | | | | | | | | | | | | | | | | | | | | | | | |
| DI | ST | TL | RV | FL | FR | NP | SM | | | | | | | | | | | | | | | | | | | | | | | | | | | | | | | | | | | | | | | | |
|  | 13.6028.000 W 725/12V | LED-Rückfahrleuchte LED Reversing Light | <table border="1"><tr><td></td><td></td><td></td><td>●</td><td></td><td></td><td></td><td></td><td></td><td></td><td></td><td></td></tr><tr><td>BL</td><td>BR</td><td>S</td><td>W</td><td>SN</td><td>R</td><td>K</td><td>SM</td><td></td><td></td><td></td><td></td></tr><tr><td>DI</td><td>ST</td><td>TL</td><td>RV</td><td>FL</td><td>FR</td><td>NP</td><td>SM</td><td></td><td></td><td></td><td></td></tr></table> | | | | ● | | | | | | | | | BL | BR | S | W | SN | R | K | SM | | | | | DI | ST | TL | RV | FL | FR | NP | SM | | | | | 12 V | 4 W | PMMA / ABS klar - clear | Kabel 500 mm cable 500 mm | 0,13 kg | IP 67 | 10 | E2-07048 |
| | | | | ● | | | | | | | | | | | | | | | | | | | | | | | | | | | | | | | | | | | | | | | | | | | |
| BL | BR | S | W | SN | R | K | SM | | | | | | | | | | | | | | | | | | | | | | | | | | | | | | | | | | | | | | | | |
| DI | ST | TL | RV | FL | FR | NP | SM | | | | | | | | | | | | | | | | | | | | | | | | | | | | | | | | | | | | | | | | |
| 13.6029.000 W 725/24V | LED-Rückfahrleuchte LED Reversing Light | <table border="1"><tr><td></td><td></td><td></td><td>●</td><td></td><td></td><td></td><td></td><td></td><td></td><td></td><td></td></tr><tr><td>BL</td><td>BR</td><td>S</td><td>W</td><td>SN</td><td>R</td><td>K</td><td>SM</td><td></td><td></td><td></td><td></td></tr><tr><td>DI</td><td>ST</td><td>TL</td><td>RV</td><td>FL</td><td>FR</td><td>NP</td><td>SM</td><td></td><td></td><td></td><td></td></tr></table> | | | | ● | | | | | | | | | BL | BR | S | W | SN | R | K | SM | | | | | DI | ST | TL | RV | FL | FR | NP | SM | | | | | 24 V | 4 W | PMMA / ABS klar - clear | Kabel 500 mm cable 500 mm | 0,13 kg | IP 67 | 10 | E2-07048 | |
| | | | ● | | | | | | | | | | | | | | | | | | | | | | | | | | | | | | | | | | | | | | | | | | | | |
| BL | BR | S | W | SN | R | K | SM | | | | | | | | | | | | | | | | | | | | | | | | | | | | | | | | | | | | | | | | |
| DI | ST | TL | RV | FL | FR | NP | SM | | | | | | | | | | | | | | | | | | | | | | | | | | | | | | | | | | | | | | | | |

Zusatz-Information:
Additional Information:

Rückstrahler und Deko-Ringe siehe: L 710
Reflex reflectors and Decoration Rims please refer to: L 710

Zubehör / Ersatzteile * Accessories / Spare parts

| | | | | | | | | | | | |
|---|------------------------------------|--|--|------|----------|-----------------------------------|----------------------------------|---------|--------------------|----|------------------|
|  | 62.3001.022 LK 100-2/12V | LED-Kontrollbox (Blinker) LED Control Device (DI) | Schaltstrom/Threshold 90mA bei / at 12V | 12 V | 2 x 21 W | Aluminium / PU schwarz - black | Kabel 2x1500mm cable 2x1500mm | 0,40 kg | -20/+50°C IP 67 | 10 | EMV / EMC E/5 |
| Zusatz-Information: Additional Information: | | geeignet für Leuchten: BBS 725/12V; BL 725/12V suitable for lights: BBS 725/12V; BL 725/12V | | | | | | | | | |

LED-LEUCHTEN-SYSTEM 280 * LED LIGHTING SYSTEM 280

Die Leuchten der Serie 280 sind anschlussfertig, wasserdicht vergossen und verfügen über ein Anschlusskabel von 500 mm. Die Leuchten sind für den Einbau vorgesehen, sind aber wegen ihrer geringen Einbautiefe auch für den Aufbau geeignet.

LED lights type 280 are ready for plug-in, they are sealed in a waterproof manner and are equipped with a connecting cable of 500 mm. These lights are used for flush fitting, but because of their small installation depth they can be used for surface mounting as well.

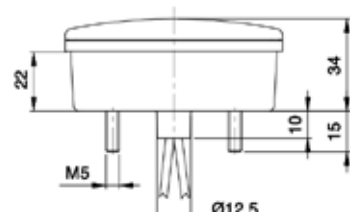

· Wasserdicht vergossen und anschlussfertig
· Einbau- oder Aufbaumontage

· sealed in a waterproof manner and ready for plug-in
· flush fitting or surface mounting

| Bild Picture | Art.-Nr. / No. Typ / Type | Beschreibung Description | Merkmale Features | Spann. Voltage | Leistung Power | Material / Farbe Material / Colour | Anschluss Connection | Gewicht Weight | IP / Temp. IP / Temp. | VP PU | Homolog. Approval | | | | | | | | | | | | | | | | | | | | | | | | | | | | |
|-----------------------------------|--|--|--|-------------------|-------------------|---------------------------------------|-------------------------|-------------------|--------------------------|----------|----------------------|----|----|----|----|----|----|---|----|----|---|----|----|----|----|----|----|----|----|----|------|---------------|----------------------------|------------------------------|------------------------------|---------|-------|----------|----------|
| | 10.0030.500 BBS 280/12V | LED-Blink-Brems-Schluss. LED DI / Stop / Tail Light | <table border="1"><tr><td>●</td><td>●</td><td>●</td><td>●</td><td>●</td><td>●</td><td>●</td><td>●</td><td>●</td><td>●</td><td>●</td><td>●</td></tr><tr><td>BL</td><td>BR</td><td>S</td><td>W</td><td>SN</td><td>R</td><td>K</td><td>SM</td><td>DI</td><td>ST</td><td>TL</td><td>RV</td><td>FL</td><td>RR</td><td>NP</td><td>SM</td></tr></table> | ● | ● | ● | ● | ● | ● | ● | ● | ● | ● | ● | ● | BL | BR | S | W | SN | R | K | SM | DI | ST | TL | RV | FL | RR | NP | SM | 12 V | 5 / 4 / 0,5 W | PMMA / ABS klar - clear | Kabel 500 mm cable 500 mm | 0,13 kg | IP 67 | 10 | E2-06069 |
| | ● | ● | ● | ● | ● | ● | ● | ● | ● | ● | ● | ● | | | | | | | | | | | | | | | | | | | | | | | | | | | |
| BL | BR | S | W | SN | R | K | SM | DI | ST | TL | RV | FL | RR | NP | SM | | | | | | | | | | | | | | | | | | | | | | | | |
| 10.0031.500 BBS 280/24V | LED-Blink-Brems-Schluss. LED DI / Stop / Tail Light | <table border="1"><tr><td>●</td><td>●</td><td>●</td><td>●</td><td>●</td><td>●</td><td>●</td><td>●</td><td>●</td><td>●</td><td>●</td><td>●</td></tr><tr><td>BL</td><td>BR</td><td>S</td><td>W</td><td>SN</td><td>R</td><td>K</td><td>SM</td><td>DI</td><td>ST</td><td>TL</td><td>RV</td><td>FL</td><td>RR</td><td>NP</td><td>SM</td></tr></table> | ● | ● | ● | ● | ● | ● | ● | ● | ● | ● | ● | ● | BL | BR | S | W | SN | R | K | SM | DI | ST | TL | RV | FL | RR | NP | SM | 24 V | 5 / 4 / 0,5 W | PMMA / ABS klar - clear | Kabel 500 mm cable 500 mm | 0,13 kg | IP 67 | 10 | E2-06069 | |
| ● | ● | ● | ● | ● | ● | ● | ● | ● | ● | ● | ● | | | | | | | | | | | | | | | | | | | | | | | | | | | | |
| BL | BR | S | W | SN | R | K | SM | DI | ST | TL | RV | FL | RR | NP | SM | | | | | | | | | | | | | | | | | | | | | | | | |
| | 10.0028.500 BLS 280/12V | LED-Blink-Schlussleuchte LED DI / Tail Light | <table border="1"><tr><td>●</td><td>●</td><td>●</td><td>●</td><td>●</td><td>●</td><td>●</td><td>●</td><td>●</td><td>●</td><td>●</td><td>●</td></tr><tr><td>BL</td><td>BR</td><td>S</td><td>W</td><td>SN</td><td>R</td><td>K</td><td>SM</td><td>DI</td><td>ST</td><td>TL</td><td>RV</td><td>FL</td><td>RR</td><td>NP</td><td>SM</td></tr></table> | ● | ● | ● | ● | ● | ● | ● | ● | ● | ● | ● | ● | BL | BR | S | W | SN | R | K | SM | DI | ST | TL | RV | FL | RR | NP | SM | 12 V | 5 / 0,5 W | PMMA / ABS klar - clear | Kabel 500 mm cable 500 mm | 0,13 kg | IP 67 | 10 | E2-06067 |
| | ● | ● | ● | ● | ● | ● | ● | ● | ● | ● | ● | ● | | | | | | | | | | | | | | | | | | | | | | | | | | | |
| BL | BR | S | W | SN | R | K | SM | DI | ST | TL | RV | FL | RR | NP | SM | | | | | | | | | | | | | | | | | | | | | | | | |
| 10.0029.500 BLS 280/24V | LED-Blink-Schlussleuchte LED DI / Tail Light | <table border="1"><tr><td>●</td><td>●</td><td>●</td><td>●</td><td>●</td><td>●</td><td>●</td><td>●</td><td>●</td><td>●</td><td>●</td><td>●</td></tr><tr><td>BL</td><td>BR</td><td>S</td><td>W</td><td>SN</td><td>R</td><td>K</td><td>SM</td><td>DI</td><td>ST</td><td>TL</td><td>RV</td><td>FL</td><td>RR</td><td>NP</td><td>SM</td></tr></table> | ● | ● | ● | ● | ● | ● | ● | ● | ● | ● | ● | ● | BL | BR | S | W | SN | R | K | SM | DI | ST | TL | RV | FL | RR | NP | SM | 24 V | 5 / 0,5 W | PMMA / ABS klar - clear | Kabel 500 mm cable 500 mm | 0,13 kg | IP 67 | 10 | E2-06067 | |
| ● | ● | ● | ● | ● | ● | ● | ● | ● | ● | ● | ● | | | | | | | | | | | | | | | | | | | | | | | | | | | | |
| BL | BR | S | W | SN | R | K | SM | DI | ST | TL | RV | FL | RR | NP | SM | | | | | | | | | | | | | | | | | | | | | | | | |
| | 10.0027.500 BRS 280/24V | LED-Brems-Schlussleuchte LED Stop / Tail Light | <table border="1"><tr><td>●</td><td>●</td><td>●</td><td>●</td><td>●</td><td>●</td><td>●</td><td>●</td><td>●</td><td>●</td><td>●</td><td>●</td></tr><tr><td>BL</td><td>BR</td><td>S</td><td>W</td><td>SN</td><td>R</td><td>K</td><td>SM</td><td>DI</td><td>ST</td><td>TL</td><td>RV</td><td>FL</td><td>RR</td><td>NP</td><td>SM</td></tr></table> | ● | ● | ● | ● | ● | ● | ● | ● | ● | ● | ● | ● | BL | BR | S | W | SN | R | K | SM | DI | ST | TL | RV | FL | RR | NP | SM | 24 V | 4 / 0,5 W | PMMA / ABS klar - clear | Kabel 500 mm cable 500 mm | 0,13 kg | IP 67 | 10 | E2-06068 |
| | ● | ● | ● | ● | ● | ● | ● | ● | ● | ● | ● | ● | | | | | | | | | | | | | | | | | | | | | | | | | | | |
| BL | BR | S | W | SN | R | K | SM | DI | ST | TL | RV | FL | RR | NP | SM | | | | | | | | | | | | | | | | | | | | | | | | |
| | 13.1039.000 BL 280/12V | LED-Blinkleuchte / Kat. 2a LED DI / Cat. 2a | <table border="1"><tr><td>●</td><td>●</td><td>●</td><td>●</td><td>●</td><td>●</td><td>●</td><td>●</td><td>●</td><td>●</td><td>●</td><td>●</td></tr><tr><td>BL</td><td>BR</td><td>S</td><td>W</td><td>SN</td><td>R</td><td>K</td><td>SM</td><td>DI</td><td>ST</td><td>TL</td><td>RV</td><td>FL</td><td>RR</td><td>NP</td><td>SM</td></tr></table> | ● | ● | ● | ● | ● | ● | ● | ● | ● | ● | ● | ● | BL | BR | S | W | SN | R | K | SM | DI | ST | TL | RV | FL | RR | NP | SM | 12 V | 5 W | PMMA / ABS klar - clear | Kabel 500 mm cable 500 mm | 0,13 kg | IP 67 | 10 | E2-06065 |
| | ● | ● | ● | ● | ● | ● | ● | ● | ● | ● | ● | ● | | | | | | | | | | | | | | | | | | | | | | | | | | | |
| BL | BR | S | W | SN | R | K | SM | DI | ST | TL | RV | FL | RR | NP | SM | | | | | | | | | | | | | | | | | | | | | | | | |
| 13.1039.500 BL 280/24V | LED-Blinkleuchte / Kat. 2a LED DI / Cat. 2a | <table border="1"><tr><td>●</td><td>●</td><td>●</td><td>●</td><td>●</td><td>●</td><td>●</td><td>●</td><td>●</td><td>●</td><td>●</td><td>●</td></tr><tr><td>BL</td><td>BR</td><td>S</td><td>W</td><td>SN</td><td>R</td><td>K</td><td>SM</td><td>DI</td><td>ST</td><td>TL</td><td>RV</td><td>FL</td><td>RR</td><td>NP</td><td>SM</td></tr></table> | ● | ● | ● | ● | ● | ● | ● | ● | ● | ● | ● | ● | BL | BR | S | W | SN | R | K | SM | DI | ST | TL | RV | FL | RR | NP | SM | 24 V | 5 W | PMMA / ABS klar - clear | Kabel 500 mm cable 500 mm | 0,13 kg | IP 67 | 10 | E2-06065 | |
| ● | ● | ● | ● | ● | ● | ● | ● | ● | ● | ● | ● | | | | | | | | | | | | | | | | | | | | | | | | | | | | |
| BL | BR | S | W | SN | R | K | SM | DI | ST | TL | RV | FL | RR | NP | SM | | | | | | | | | | | | | | | | | | | | | | | | |
| | 13.3028.500 SN 280/12V | LED-Nebelschlussleuchte LED Fog Light | <table border="1"><tr><td>●</td><td>●</td><td>●</td><td>●</td><td>●</td><td>●</td><td>●</td><td>●</td><td>●</td><td>●</td><td>●</td><td>●</td></tr><tr><td>BL</td><td>BR</td><td>S</td><td>W</td><td>SN</td><td>R</td><td>K</td><td>SM</td><td>DI</td><td>ST</td><td>TL</td><td>RV</td><td>FL</td><td>RR</td><td>NP</td><td>SM</td></tr></table> | ● | ● | ● | ● | ● | ● | ● | ● | ● | ● | ● | ● | BL | BR | S | W | SN | R | K | SM | DI | ST | TL | RV | FL | RR | NP | SM | 12 V | 3 W | PMMA / ABS klar - clear | Kabel 500 mm cable 500 mm | 0,13 kg | IP 67 | 10 | E2-06063 |
| | ● | ● | ● | ● | ● | ● | ● | ● | ● | ● | ● | ● | | | | | | | | | | | | | | | | | | | | | | | | | | | |
| BL | BR | S | W | SN | R | K | SM | DI | ST | TL | RV | FL | RR | NP | SM | | | | | | | | | | | | | | | | | | | | | | | | |
| 13.3029.500 SN 280/24V | LED-Nebelschlussleuchte LED Fog Light | <table border="1"><tr><td>●</td><td>●</td><td>●</td><td>●</td><td>●</td><td>●</td><td>●</td><td>●</td><td>●</td><td>●</td><td>●</td><td>●</td></tr><tr><td>BL</td><td>BR</td><td>S</td><td>W</td><td>SN</td><td>R</td><td>K</td><td>SM</td><td>DI</td><td>ST</td><td>TL</td><td>RV</td><td>FL</td><td>RR</td><td>NP</td><td>SM</td></tr></table> | ● | ● | ● | ● | ● | ● | ● | ● | ● | ● | ● | ● | BL | BR | S | W | SN | R | K | SM | DI | ST | TL | RV | FL | RR | NP | SM | 24 V | 3 W | PMMA / ABS klar - clear | Kabel 500 mm cable 500 mm | 0,13 kg | IP 67 | 10 | E2-06063 | |
| ● | ● | ● | ● | ● | ● | ● | ● | ● | ● | ● | ● | | | | | | | | | | | | | | | | | | | | | | | | | | | | |
| BL | BR | S | W | SN | R | K | SM | DI | ST | TL | RV | FL | RR | NP | SM | | | | | | | | | | | | | | | | | | | | | | | | |
| | 13.6026.000 W 280/12V | LED-Rückfahrleuchte LED Reversing Light | <table border="1"><tr><td>●</td><td>●</td><td>●</td><td>●</td><td>●</td><td>●</td><td>●</td><td>●</td><td>●</td><td>●</td><td>●</td><td>●</td></tr><tr><td>BL</td><td>BR</td><td>S</td><td>W</td><td>SN</td><td>R</td><td>K</td><td>SM</td><td>DI</td><td>ST</td><td>TL</td><td>RV</td><td>FL</td><td>RR</td><td>NP</td><td>SM</td></tr></table> | ● | ● | ● | ● | ● | ● | ● | ● | ● | ● | ● | ● | BL | BR | S | W | SN | R | K | SM | DI | ST | TL | RV | FL | RR | NP | SM | 12 V | 3 W | PMMA / ABS klar - clear | Kabel 500 mm cable 500 mm | 0,13 kg | IP 67 | 10 | E2-06064 |
| | ● | ● | ● | ● | ● | ● | ● | ● | ● | ● | ● | ● | | | | | | | | | | | | | | | | | | | | | | | | | | | |
| BL | BR | S | W | SN | R | K | SM | DI | ST | TL | RV | FL | RR | NP | SM | | | | | | | | | | | | | | | | | | | | | | | | |
| 13.6027.000 W 280/24V | LED-Rückfahrleuchte LED Reversing Light | <table border="1"><tr><td>●</td><td>●</td><td>●</td><td>●</td><td>●</td><td>●</td><td>●</td><td>●</td><td>●</td><td>●</td><td>●</td><td>●</td></tr><tr><td>BL</td><td>BR</td><td>S</td><td>W</td><td>SN</td><td>R</td><td>K</td><td>SM</td><td>DI</td><td>ST</td><td>TL</td><td>RV</td><td>FL</td><td>RR</td><td>NP</td><td>SM</td></tr></table> | ● | ● | ● | ● | ● | ● | ● | ● | ● | ● | ● | ● | BL | BR | S | W | SN | R | K | SM | DI | ST | TL | RV | FL | RR | NP | SM | 24 V | 3 W | PMMA / ABS klar - clear | Kabel 500 mm cable 500 mm | 0,13 kg | IP 67 | 10 | E2-06064 | |
| ● | ● | ● | ● | ● | ● | ● | ● | ● | ● | ● | ● | | | | | | | | | | | | | | | | | | | | | | | | | | | | |
| BL | BR | S | W | SN | R | K | SM | DI | ST | TL | RV | FL | RR | NP | SM | | | | | | | | | | | | | | | | | | | | | | | | |

Zubehör / Ersatzteile * Accessories / Spare parts

| | | | | | | | | | | | |
|--|--|--|--|------|----------|-----------------------------------|----------------------------------|---------|--------------------|---|-----------|
| | 62.3001.022 LK 100-2/12V | LED-Kontrollbox (Blinker) LED Control Device (DI) | Schwellenwert 90 mA (I=const.) | 12 V | 2 x 21 W | Aluminium / PU schwarz - black | Kabel 2x1500mm cable 2x1500mm | 0,40 kg | -20/+50°C IP 67 | 1 | EMV / EMC |
| | Zusatz-Information: Additional Information: | | geeignet für Leuchte: BBS 280/12V suitable for light: BBS 280/12V | | | | | | | | |
| | 62.3002.022 LK 100-2/24V | LED-Kontrollbox (Blinker) LED Control Device (DI) | Schwellenwert 50mA bei /at 24V | 24 V | 2 x 21 W | Aluminium / PU schwarz - black | Kabel 2x1500mm cable 2x1500mm | 0,40 kg | -20/+50°C IP 67 | 1 | EMV / EMC |
| | Zusatz-Information: Additional Information: | | geeignet für Leuchte: BL 280/24V suitable for light: BL 280/24V | | | | | | | | |

LEUCHTEN-SYSTEM 65 * LIGHTING-SYSTEM 65

Die Leuchtengeneration L65 vereint zwei wichtige Merkmale in einem Produkt: Sie hat keine sichtbaren Befestigungsschrauben und ist dennoch im Falle eines Glühlampen-Austauschs von außen durch ein zuverlässiges Edelstahl-Federsystem entnehmbar. Entsprechend sieht sie an Ihrem Fahrzeug hervorragend aus und erleichtert die Wartungsarbeiten enorm, da keine Verkleidungs-Elemente demontiert werden müssen. Die Leuchte ist mit einem platzsparenden Winkel-Glühlampenhalter ausgestattet und die Glühlampe ist bereits vormontiert.

The L65 light generation combines two essential characteristics in a single product: it does not have any visible fixing screws but is nevertheless removable from the exterior if a bulb needs to be replaced. Accordingly, it looks splendid on your vehicle and maintenance is very easy, as no cladding elements need to be disassembled. The light is equipped with a space-saving angular bulb holder and the bulb is already preinstalled.

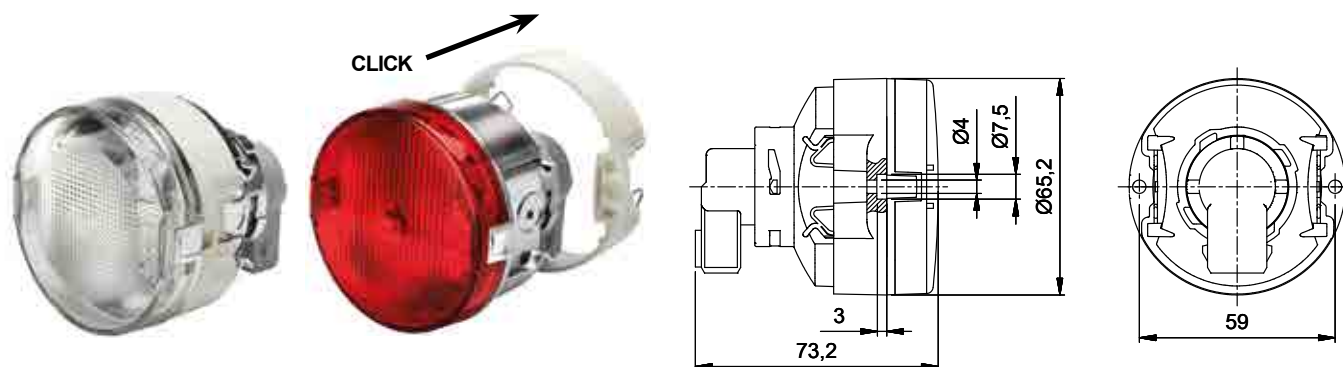

- Einbau Montage
- Inkl. Halter aus glasfaser-verstärktem Polyamid mit Klemmfeder
- Halter-Befestigung: Flachkopf-Schrauben 4 mm
- Inkl. 90° abgewinkelter Glühlampenhalter und vormontierter Glühlampe
- designed for flush mounting
- incl. polyamide holder with clip springs
- holder fixing: 4 mm flat-head screws
- incl. 90° angular connector and installed bulb

| Bild Picture | Art.-Nr. / No. Typ / Type | Beschreibung Description | Merkmale Features | Spann. Voltage | Leistung Power | Material / Farbe Material / Colour | Anschluss Connection | Gewicht Weight | IP / Temp. IP / Temp. | VP PU | Homolog. Approval | | | | | | | | | | | | | | | | |
|-----------------|-----------------------------------|---|---|-------------------|-------------------|---------------------------------------|-------------------------|-------------------|--------------------------|----------|----------------------|----|----|----|----|----|----|----|----|---------|-----------|---------------------------|--------------------------------------|---------|----------------------|----|-----------|
| | 13.1058.000 BL 65/12V | Blinkleuchte / Kat. 2a Direction indicator / Cat. 2a | <table border="0"> <tr> <td>BL</td><td>BR</td><td>S</td><td>W</td><td>SN</td><td>R</td><td>K</td><td>SM</td> </tr> <tr> <td>DI</td><td>ST</td><td>TL</td><td>RV</td><td>FL</td><td>FR</td><td>NP</td><td>SM</td> </tr> </table> | BL | BR | S | W | SN | R | K | SM | DI | ST | TL | RV | FL | FR | NP | SM | 12 V DC | PY 21 W | APEC / PA weiß - white | Winkel-Gl.-Halter angular connec. | 0,07 kg | -20 / +40°C IP 67 | 10 | E13-13836 |
| BL | BR | S | W | SN | R | K | SM | | | | | | | | | | | | | | | | | | | | |
| DI | ST | TL | RV | FL | FR | NP | SM | | | | | | | | | | | | | | | | | | | | |
| | 10.0011.000 BRS 65/12V | Brems-Schlussleuchte Stop / Tail Light | <table border="0"> <tr> <td>BL</td><td>BR</td><td>S</td><td>W</td><td>SN</td><td>R</td><td>K</td><td>SM</td> </tr> <tr> <td>DI</td><td>ST</td><td>TL</td><td>RV</td><td>FL</td><td>FR</td><td>NP</td><td>SM</td> </tr> </table> | BL | BR | S | W | SN | R | K | SM | DI | ST | TL | RV | FL | FR | NP | SM | 12 V DC | P 21/5 W | APEC / PA rot - red | Winkel-Gl.-Halter angular connec. | 0,07 kg | -20 / +40°C IP 67 | 10 | E13-13835 |
| BL | BR | S | W | SN | R | K | SM | | | | | | | | | | | | | | | | | | | | |
| DI | ST | TL | RV | FL | FR | NP | SM | | | | | | | | | | | | | | | | | | | | |
| | 10.0011.300 BRS 65w/12V | Brems-Schlussleuchte Stop / Tail Light | <table border="0"> <tr> <td>BL</td><td>BR</td><td>S</td><td>W</td><td>SN</td><td>R</td><td>K</td><td>SM</td> </tr> <tr> <td>DI</td><td>ST</td><td>TL</td><td>RV</td><td>FL</td><td>FR</td><td>NP</td><td>SM</td> </tr> </table> | BL | BR | S | W | SN | R | K | SM | DI | ST | TL | RV | FL | FR | NP | SM | 12 V DC | PR 21/5 W | APEC / PA rot - red | Winkel-Gl.-Halter angular connec. | 0,07 kg | -20 / +40°C IP 67 | 10 | E13-13835 |
| BL | BR | S | W | SN | R | K | SM | | | | | | | | | | | | | | | | | | | | |
| DI | ST | TL | RV | FL | FR | NP | SM | | | | | | | | | | | | | | | | | | | | |
| | 13.3008.000 SN 65/12V | Nebelschlussleuchte Fog Light | <table border="0"> <tr> <td>BL</td><td>BR</td><td>S</td><td>W</td><td>SN</td><td>R</td><td>K</td><td>SM</td> </tr> <tr> <td>DI</td><td>ST</td><td>TL</td><td>RV</td><td>FL</td><td>FR</td><td>NP</td><td>SM</td> </tr> </table> | BL | BR | S | W | SN | R | K | SM | DI | ST | TL | RV | FL | FR | NP | SM | 12 V DC | P 21 W | APEC / PA rot - red | Winkel-Gl.-Halter angular connec. | 0,07 kg | -20 / +40°C IP 67 | 10 | E13-13624 |
| BL | BR | S | W | SN | R | K | SM | | | | | | | | | | | | | | | | | | | | |
| DI | ST | TL | RV | FL | FR | NP | SM | | | | | | | | | | | | | | | | | | | | |
| | 13.3008.300 SN 65w/12V | Nebelschlussleuchte Fog Light | <table border="0"> <tr> <td>BL</td><td>BR</td><td>S</td><td>W</td><td>SN</td><td>R</td><td>K</td><td>SM</td> </tr> <tr> <td>DI</td><td>ST</td><td>TL</td><td>RV</td><td>FL</td><td>FR</td><td>NP</td><td>SM</td> </tr> </table> | BL | BR | S | W | SN | R | K | SM | DI | ST | TL | RV | FL | FR | NP | SM | 12 V DC | PR 21 W | APEC / PA rot - red | Winkel-Gl.-Halter angular connec. | 0,07 kg | -20 / +40°C IP 67 | 10 | E13-13624 |
| BL | BR | S | W | SN | R | K | SM | | | | | | | | | | | | | | | | | | | | |
| DI | ST | TL | RV | FL | FR | NP | SM | | | | | | | | | | | | | | | | | | | | |
| | 13.6036.000 W 65/12V | Rückfahrleuchte Reversing Light | <table border="0"> <tr> <td>BL</td><td>BR</td><td>S</td><td>W</td><td>SN</td><td>R</td><td>K</td><td>SM</td> </tr> <tr> <td>DI</td><td>ST</td><td>TL</td><td>RV</td><td>FL</td><td>FR</td><td>NP</td><td>SM</td> </tr> </table> | BL | BR | S | W | SN | R | K | SM | DI | ST | TL | RV | FL | FR | NP | SM | 12 V DC | P 21 W | APEC / PA weiß - white | Winkel-Gl.-Halter angular connec. | 0,07 kg | -20 / +40°C IP 67 | 10 | E13-13635 |
| BL | BR | S | W | SN | R | K | SM | | | | | | | | | | | | | | | | | | | | |
| DI | ST | TL | RV | FL | FR | NP | SM | | | | | | | | | | | | | | | | | | | | |
| | 13.2007.000 BR 65/12V | Bremsleuchte Stop Light | <table border="0"> <tr> <td>BL</td><td>BR</td><td>S</td><td>W</td><td>SN</td><td>R</td><td>K</td><td>SM</td> </tr> <tr> <td>DI</td><td>ST</td><td>TL</td><td>RV</td><td>FL</td><td>FR</td><td>NP</td><td>SM</td> </tr> </table> | BL | BR | S | W | SN | R | K | SM | DI | ST | TL | RV | FL | FR | NP | SM | 12 V DC | P 21 W | APEC / PA rot - red | Winkel-Gl.-Halter angular connec. | 0,07 kg | -20 / +40°C IP 67 | 10 | E13-13857 |
| BL | BR | S | W | SN | R | K | SM | | | | | | | | | | | | | | | | | | | | |
| DI | ST | TL | RV | FL | FR | NP | SM | | | | | | | | | | | | | | | | | | | | |

Zubehör / Ersatzteile * Accessories / Spare parts



| | | | | | | | | | | | |
|--|-------------------------------|--|--|--|--|-------------------|--|----------|--|-----|-----------|
| | 30.0019.000 R 65/95 | Rückstrahler Reflex Reflector | | | | PMMA rot - red | | | | 100 | E13-14244 |
| | auf Anfrage/on request | Deko-Ring Decoration Rim | verchromt chrome | | | | | | | | |
| | 19.5026.000 | Entriegelungswerkzeug Lock-out release tool | Leuchten System 65 Lighting system 65 | | | | | 0,004 kg | | | |

LEUCHTEN-SYSTEM 710 mit KLARGLASOPTIK * LIGHTING SYSTEM 710 with CLEAR OPTICS

Die Leuchten der Serie 710 sind mittels einem in verschiedenen Farben lieferbaren Zierring auf einen Durchmesser von 122 mm vergrößerbar. Die Leuchten sind für den Einbau vorgesehen.

Lights type 710 can be extended by a decoration rim to a diameter of 122 mm available in different colours. These lights are used for flush fitting.

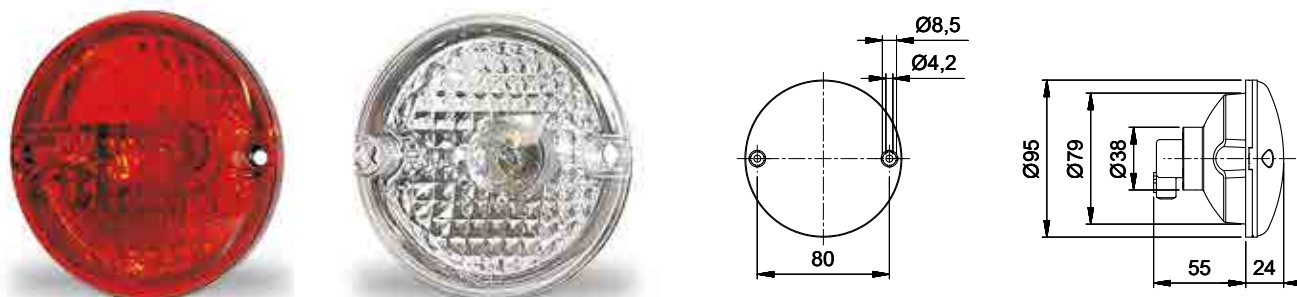

| | | · Mit montierten Glühlampen · Abgewinkelter Glühlampenhalter | | | | · with fitted bulbs · angled bulb-holder | | | | | |
|-----------------|-----------------------------------|---|----------------------|-------------------|-------------------|---|--------------------------------------|-------------------|--------------------------|----------|----------------------|
| Bild Picture | Art.-Nr. / No. Typ / Type | Beschreibung Description | Merkmale Features | Spann. Voltage | Leistung Power | Material / Farbe Material / Colour | Anschluss Connection | Gewicht Weight | IP / Temp. IP / Temp. | VP PU | Homolog. Approval |
| | 10.0005.500 BRS 710/12V | Brems-Schlussleuchte Stop / Tail Light | | 12 V | P 21 / 5 W | PC / ABS rot - red | Winkel-Gl.-Halter angular connec. | 0,08 kg | | 10 | E1-1542 |
| | 13.1019.500 BL 710/12V | Blinkleuchte / Kat. 2a DI Light / Cat.2a | | 12 V | P 21 W | PC / ABS gelb - yellow | Winkel-Gl.-Halter angular connec. | 0,08 kg | | 10 | E1-1547 |
| | 13.1031.500 BL 710/12V | Blinkleuchte / Kat. 2a DI Light / Cat.2a | | 12 V | PY 21 W | PC / ABS klar - clear | Winkel-Gl.-Halter angular connec. | 0,08 kg | | 10 | E1-1547 |
| | 13.3016.500 SN 710/12V | Nebelschlussleuchte Fog Light | | 12 V | P 21 W | PC / ABS rot - red | Winkel-Gl.-Halter angular connec. | 0,08 kg | | 10 | E1-1543 |
| | 13.6011.500 W 710/12V | Rückfahrleuchte Reversing Light | | 12 V | P 21 W | PC / ABS klar - clear | Winkel-Gl.-Halter angular connec. | 0,08 kg | | 10 | E1-1544 |

Zubehör / Ersatzteile * Accessories / Spare parts

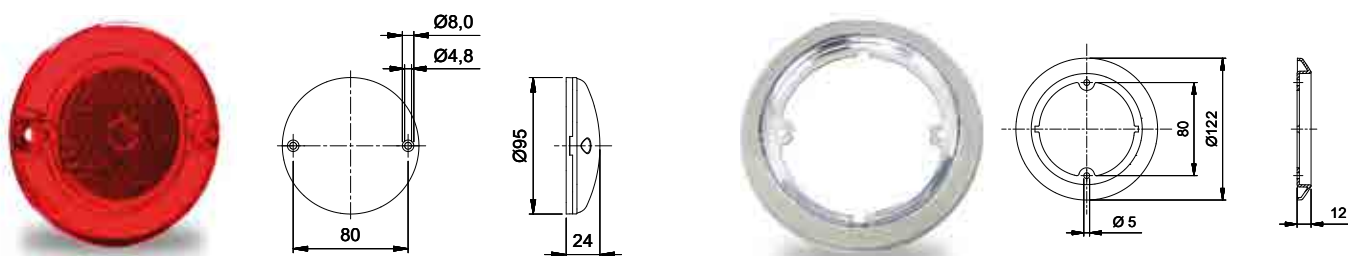

| | | | | | | | | | | | |
|--|------------------------------|----------------------------------|-------------------------------|--|--|-------------------------|--|---------|--|-----|--|
| | 30.0016.000 R 710r | Rückstrahler Reflex Reflector | klarglasoptik clear optics | | | PMMA / SAN rot - red | | 0,06 kg | | 100 | |
| | 19.2016.000 | Deko-Ring Decoration Rim | versp./hochglanz chrome | | | SAN chrom - chrome | | 0,02 kg | | 50 | |
| | 19.2016.100 | Deko-Ring Decoration Rim | versp./hochglanz chrome | | | SAN rot - red | | 0,02 kg | | 50 | |
| | 19.2016.200 | Deko-Ring Decoration Rim | versp./hochglanz chrome | | | SAN gelb - yellow | | 0,02 kg | | 50 | |

Zusatz-Information:
Additional Information:

Deko-Ringe für Leuchten-Systeme 710 / 720 / 725
Decoration Rims for Lighting Systems 710 / 720 / 725